

REVIEW ONLY
 DOCUMENT NOT
 INTENDED FOR
 PERMIT, BIDDING OR
 CONSTRUCTION
 MALTZ ENGINEERING LLC
 TIMOTHY M. MALTZ, P.E.
 TX. PE # 94231
 DATE: 12-01-2017

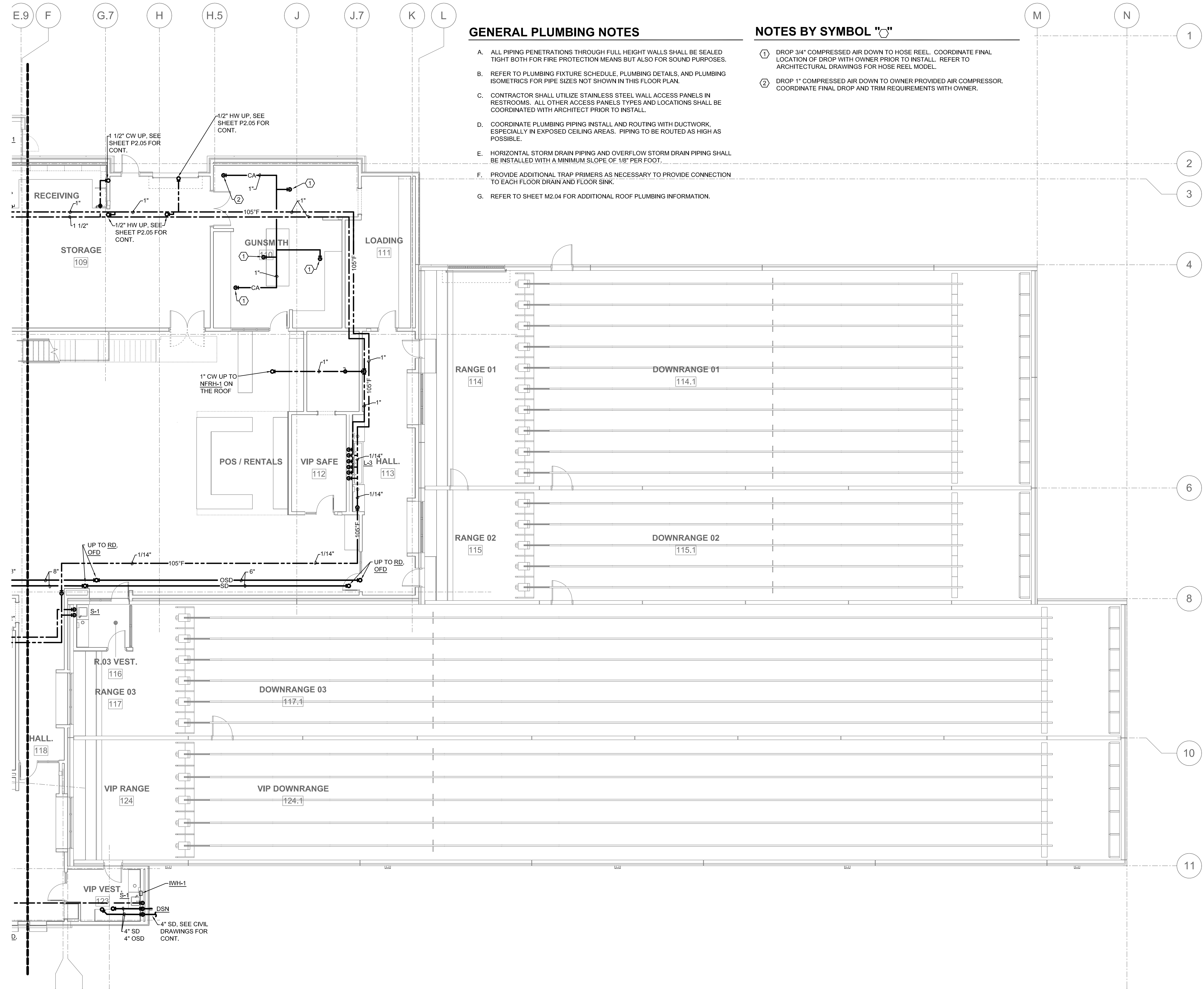

GENERAL PLUMBING NOTES

- A. ALL PIPING PENETRATIONS THROUGH FULL HEIGHT WALLS SHALL BE SEALED TIGHT BOTH FOR FIRE PROTECTION MEANS BUT ALSO FOR SOUND PURPOSES.
- B. REFER TO PLUMBING FIXTURE SCHEDULE, PLUMBING DETAILS, AND PLUMBING ISOMETRICS FOR PIPE SIZES NOT SHOWN IN THIS FLOOR PLAN.
- C. CONTRACTOR SHALL UTILIZE STAINLESS STEEL WALL ACCESS PANELS IN RESTROOMS. ALL OTHER ACCESS PANELS TYPES AND LOCATIONS SHALL BE COORDINATED WITH ARCHITECT PRIOR TO INSTALL.
- D. COORDINATE PLUMBING PIPING INSTALL AND ROUTING WITH DUCTWORK, ESPECIALLY IN EXPOSED CEILING AREAS. PIPING TO BE ROUTED AS HIGH AS POSSIBLE.
- E. HORIZONTAL STORM DRAIN PIPING AND OVERFLOW STORM DRAIN PIPING SHALL BE INSTALLED WITH A MINIMUM SLOPE OF 1/8" PER FOOT.
- F. PROVIDE ADDITIONAL TRAP PRIMERS AS NECESSARY TO PROVIDE CONNECTION TO EACH FLOOR DRAIN AND FLOOR SINK.
- G. REFER TO SHEET M2.04 FOR ADDITIONAL ROOF PLUMBING INFORMATION.

NOTES BY SYMBOL "1"

- ① DROP 3/4" COMPRESSED AIR DOWN TO HOSE REEL. COORDINATE FINAL LOCATION OF DROP WITH OWNER PRIOR TO INSTALL. REFER TO ARCHITECTURAL DRAWINGS FOR HOSE REEL MODEL.
- ② DROP 1" COMPRESSED AIR DOWN TO OWNER PROVIDED AIR COMPRESSOR. COORDINATE FINAL DROP AND TRIM REQUIREMENTS WITH OWNER.

Revision Schedule

Rev. #	Revision Description	Revision Date

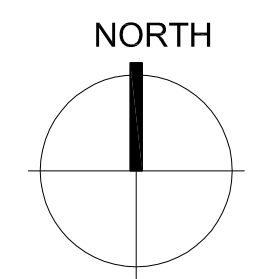

MALTZ engineering
 LLC

Firm #: 11112 2801 Carmel St
 Phone: 940-382-0949 Denton, TX 76205

**TEXAS GUN
 EXPERIENCE**
 GRAPEVINE, TEXAS

2016-028-00
 DECEMBER 1, 2017

**PLUMBING FLOOR
 PLAN - LEVEL 1 - AREA B -
 WATER**

P2.04