



**REFLECTED CEILING PLAN LEGEND**

TYPE	A
ELEVATION	9'-0"
DETAIL NUMBER	1
SHEET, LOCATED ON	A9.2

**CEILING TYPES**

- TYPE A** 5/8" GYPSUM BOARD CEILING, PAINTED, NON-SAG, CEILING RATED.
- TYPE B** 2' x 2' LAY-IN, ACOUSTICAL, CEILING TILE WITH TEGULAR EDGE IN SUSPENDED GRID.
- TYPE C** 2' x 2' LAY-IN, VINYL FACED, ACOUSTICAL CEILING TILE IN SUSPENDED GRID.
- TYPE D** 2' x 2' LAY-IN, TIN, CEILING TILE IN SUSPENDED GRID.
- TYPE E** 1 x 6 TONGUE & GROOVE, STAINED, WOOD CEILING.
- TYPE X** OPEN CEILING, EXPOSED STRUCTURE AND DUCTWORK, PAINTED.

**EQUIPMENT**

- AHR** GENERAL AIR HOSE REEL  
MODEL NO. A5825 OLP  
MANUFACTURER: REELCRAFT  
WWW.REELCRAFT.COM

- NOTES:**
1. REFERENCE ELECTRICAL DRAWINGS FOR LIGHTING FIXTURE SCHEDULE.
  2. MECHANICAL AND ELECTRICAL DATA SHOWN FOR REFERENCE ONLY. COORDINATE WITH MECHANICAL AND ELECTRICAL DRAWINGS FOR LIGHT FIXTURES, DUCTS, AND GRILLES. ANY CONFLICT OR DISCREPANCY SHALL BE ADDRESSED WITH THE ARCHITECT AS SOON AS POSSIBLE, PRIOR TO INSTALLATION.
  3. LIGHT FIXTURES ARE LOCATED TO CENTERLINE OF ROOM, CORRIDOR, OR GRID AND EQUALLY SPACED UNLESS NOTED OTHERWISE.

NOT FOR REGULATORY APPROVAL, PERMITTING, OR CONSTRUCTION

JIM THARP  
01 DECEMBER 2017  
DRAWINGS, SPECIFICATIONS AND OTHER DOCUMENTS, PREPARED BY OXLEY WILLIAMS THARP ARCHITECTS, PLLC ARE INSTRUMENTS OF SERVICE FOR USE SOLELY WITH RESPECT TO THIS PROJECT. THIS INCLUDES DOCUMENTS IN ELECTRONIC FORM. OXLEY WILLIAMS THARP ARCHITECTS, PLLC SHALL BE DEEMED THE AUTHORS AND OWNERS OF THEIR RESPECTIVE INSTRUMENTS OF SERVICE AND SHALL RETAIN ALL COMMON LAW, STATUTORY AND OTHER RESERVED RIGHTS, INCLUDING COPYRIGHTS. THE INSTRUMENTS OF SERVICE SHALL NOT BE USED BY THE OWNER FOR FUTURE ADDITIONS OR ALTERATIONS TO THIS PROJECT OR FOR OTHER PROJECTS, WITHOUT THE PRIOR WRITTEN AGREEMENT OF OXLEY WILLIAMS THARP ARCHITECTS, PLLC. ANY UNAUTHORIZED USE OF THE INSTRUMENTS OF SERVICE SHALL BE WITHOUT LIABILITY TO OXLEY WILLIAMS THARP ARCHITECTS, PLLC AND ITS CONSULTANTS.

Revision Schedule		
Rev. #	Revision Description	Revision Date

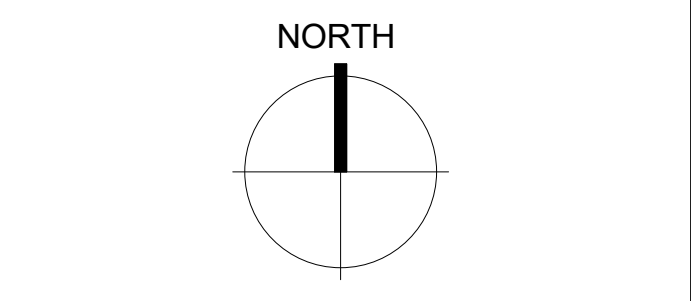
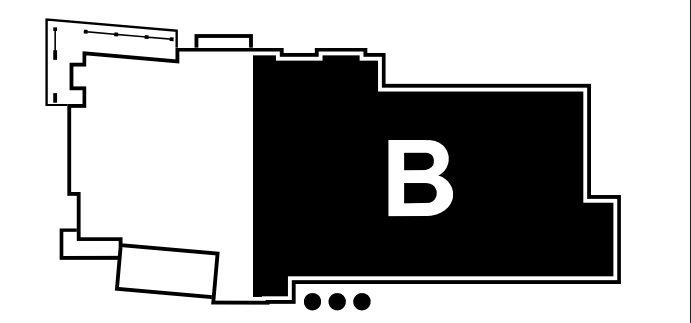

**OWT ARCHITECTS**  
509 PECAN STREET SUITE 100  
FORT WORTH, TX 76102  
817.993.9844  
www.owtarchitects.com

**TEXAS GUN EXPERIENCE**  
1901 SOUTH MAIN STREET  
GRAPEVINE, TEXAS 76051

REFLECTED CEILING PLAN - LEVEL 1 - AREA B