

THIS DOCUMENT IS RELEASED ON 12-1-17 FOR THE PURPOSE OF BIDDING ONLY UNDER THE AUTHORITY OF BRYAN WADE GREEN, P.E. 74453. IT IS NOT TO BE USED FOR CONSTRUCTION OR FABRICATION PURPOSES.

PLAN NOTES:

1. IT SHALL BE THE CONTRACTOR'S RESPONSIBILITY TO VERIFY ALL DIMENSIONS AND ELEVATIONS PRIOR TO BEGINNING CONSTRUCTION.
2. REFER TO SHEET S0.1 AND S0.2 FOR GENERAL NOTES.
3. REFER TO SHEET S3.1 FOR TYPICAL DETAILS NOT NOTED ON PLAN.
4. REFER TO 3/S3.1 FOR TYPICAL MECHANICAL UNIT CURB SUPPORT DETAIL.
5. PLANK LAYOUT AND OPENING LOCATIONS SHALL BE COORDINATED WITH PRECAST CONCRETE PLANK SUPPLIER BEFORE PLANK FABRICATION BEGINS.
6. PLANKS WHICH ARE CUT OR MODIFIED IN ANY MANNER SHALL BE MADE TO MATCH UNMODIFIED PLANK TEXTURE, SHAPE, AND CHAMFERS.
7. BOTTOM OF PLANKS SHALL BE CONSISTENT BETWEEN PLANKS. ADJACENT PLANKS WITH DIFFERENT SPANS SHALL BE PROVIDED WITH THE APPROPRIATE CAMBER SO THAT THE BOTTOM OF THE PLANKS ARE FLUSH AFTER ERECTION, SHIM AS NECESSARY.
8. JOINTS AND GAPS BETWEEN PLANKS AND WALLS BELOW SHALL BE FILLED SOLID WITH GROUT.

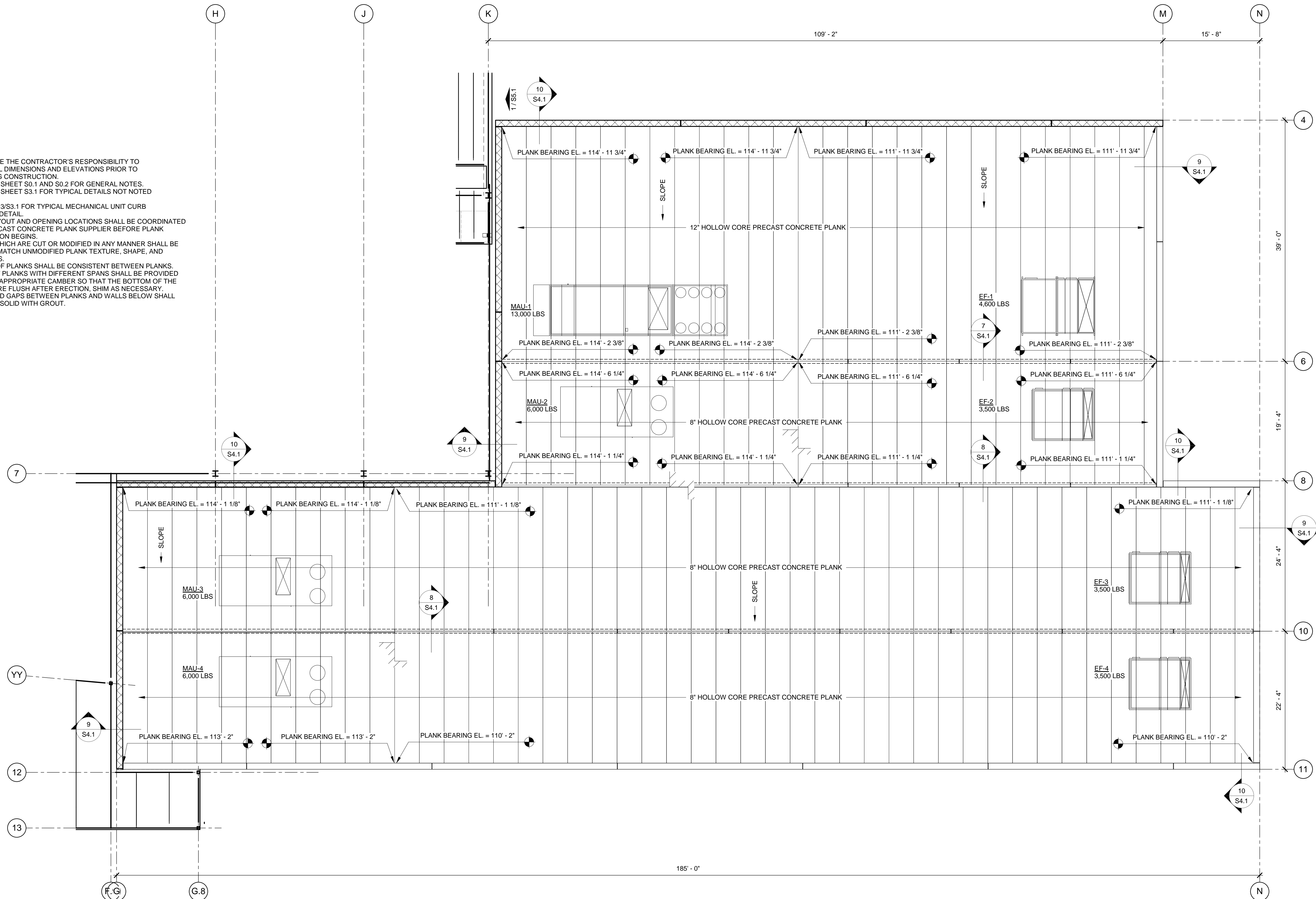

Revision Schedule		
Rev. #	Revision Description	Revision Date

**FWN&A**  
 Frank W. Neal & Assoc., Inc.  
 1015 W. Broadway Ave. Fort Worth, TX 76104  
 Texas firm reg. no. F-000296 817-332-1944 fwna-eng.com

**TEXAS GUN EXPERIENCE**  
 GRAPEVINE, TX

217.130.03  
 DECEMBER 1, 2017

**RANGE ROOF FRAMING PLAN**

**1 PLAN**

1/8" = 1'-0" Range Roof Framing Plan

**S2.6**