

**Civil Engineer**  
SCHRICKEL, ROLLINS  
AND ASSOCIATES, INC.  
1101 CORPORATE DRIVE WEST  
SUITE 200  
ARLINGTON, TEXAS 76006  
P: 817.649.3216

**Mechanical, Electrical,  
Plumbing Engineer**  
MEP SYSTEMS  
918 DRAGON STREET  
DALLAS, TEXAS 75207  
P: 214.915.0929

**Structural Engineer**  
RONALD A. ROBERTS ASSOCIATES, INC.  
2348 N. STEMMONS FREEWAY  
DALLAS, TEXAS 75207  
P: 214.637.6299

**Kitchen Consultant**  
PROFITABLE FOOD FACILITIES  
14028 Dorn Drive  
POWAY, CALIFORNIA 92064  
P: 858.748.7333

**A/V Consultant**  
ACHIEVE AV, INC.  
730 World Dr.  
CEDAR HILL, TEXAS 75104  
P: 214.884.5951



No.	Date
Revisions	
Project No.	21538.00
Drawn	-CH -XT -MW -HP
Checked	-MDS
Approved	
Key:	



**CONSTRUCTION DOCUMENTS**

Title: **PAVING & JOINTING PLAN**

Drawing No. **C8.01**

Issue Date: **OCTOBER 25, 2017**

**LEGEND:**

- DEJ DOWELED EXPANSION JOINT PER DET. 3 7 & 8/C10.02
- SAW CUT CONTROL JOINT PER DET. 2 & 3/C10.02
- 5" THICK CONCRETE PAVING PER DET. 3 & 4/C10.02
- 6" THICK CONCRETE PAVING PER DET. 2 & 4/C10.02
- 7" THICK CONCRETE PAVING PER DET. 2 & 4/C10.02

**JOINTING NOTES:**

1. EXPANSION JOINTS SHALL BE PLACED;
  - a. AROUND SITE IMPROVEMENTS THAT ARE LOCATED WITHIN PROPOSED PAVING (i.e., LIGHT POLES, MANHOLES).
  - b. WHERE PROPOSED PAVING ABUTS BUILDING FOUNDATIONS.
2. DOWELED EXPANSION JOINTS SHALL BE PLACED;
  - a. WHERE PROPOSED PAVING ABUTS EXISTING PAVING.
  - b. WHERE SHOWN ON PLANS.
3. SLOPES ON ACCESSIBLE ROUTE SHALL NOT EXCEED 5% LONGITUDINAL SLOPE AND 2% CROSSLOPE.
4. SLOPES ON ACCESSIBLE PARKING SPACES SHALL NOT EXCEED 2% IN ANY DIRECTION.

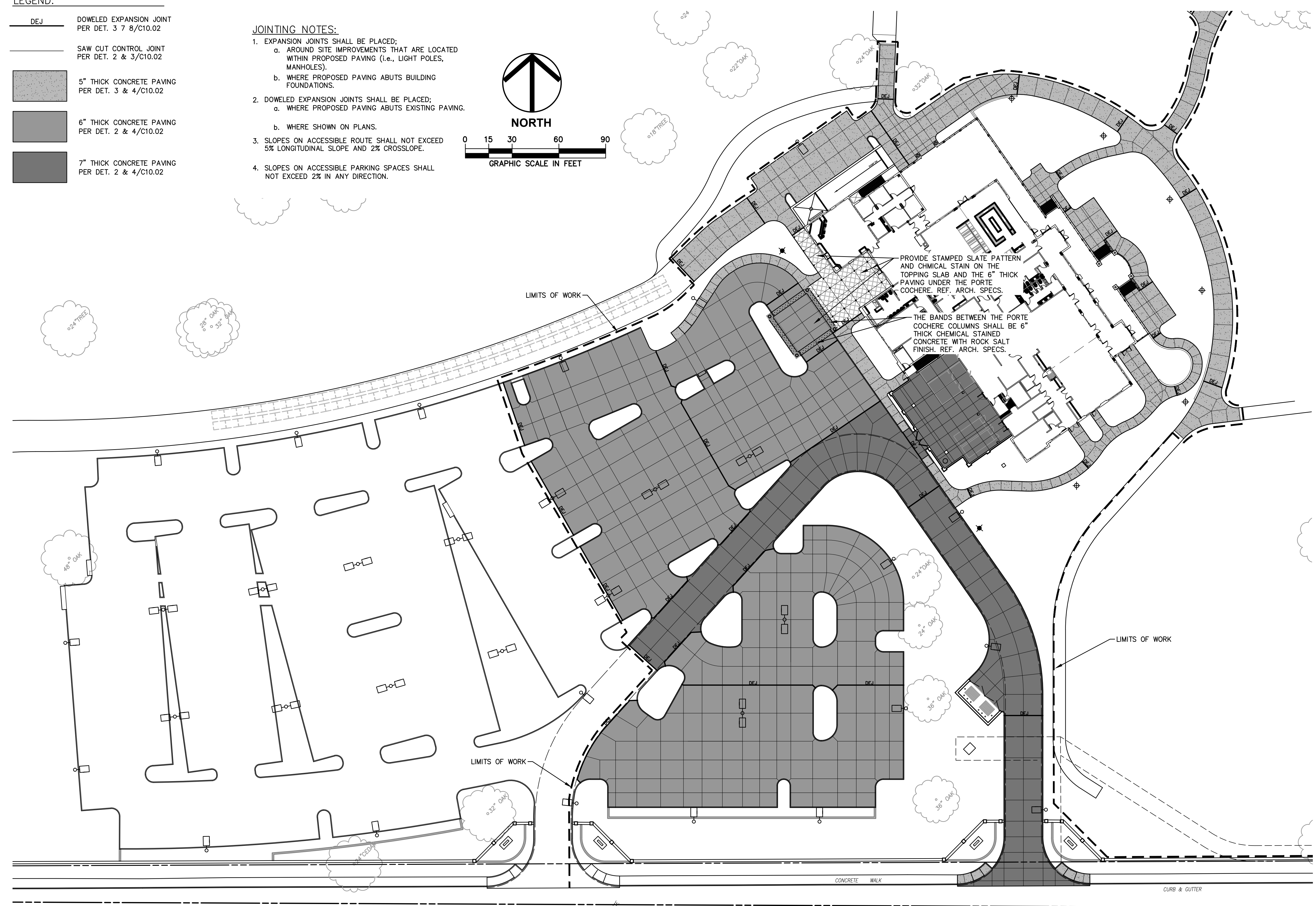
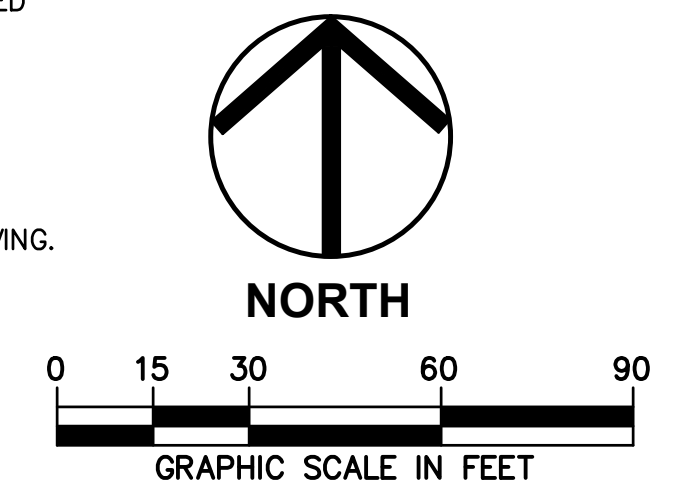

**BROWN BOULEVARD**