

SCOPE OF SITE WORK SUMMARY: PARKING LOT PACKAGE

THE PORTION OF THE PARKING LOT, ENTRY DRIVE AND GOLF CART PATH, AS INDICATED BY THE HEAVY DASHED LINE, IS BEING CONSTRUCTED UNDER A SEPARATE CONTRACT. THE SCOPE OF WORK UNDER THIS PARKING LOT CONTRACT INCLUDES:

- EARTHWORK
- SUB-GRADE PREPARATION AND PAVING
- CURB RAMPS AT MAIN ENTRANCE
- PARKING LOT STRIPING
- PARKING LOT LIGHTING
- IRRIGATION SLEEVES
- STORM DRAIN SYSTEM (STUBBED OUT FOR CONNECTION TO IN THE CLUBHOUSE PACKAGE)
- WATER MAIN TAP, 8" WATER MAIN LINE (STUBBED OUT FOR CONNECTION TO IN CLUBHOUSE PACKAGE) AND TEMPORARY 1" WATER SERVICE FOR TEMPORARY CLUBHOUSE.
- SANITARY SEWER TAP FOR TEMPORARY CLUBHOUSE.

WORK THAT IS NOT UNDER THE PARKING LOT CONTRACT (N.I.C.) INCLUDES:

- FINE GRADING IN AND AROUND THE PERIMETER OF THE PARKING LOT
- CONCRETE MOW EDGES
- LANDSCAPE BED AND ISLAND PREPARATION
- LANDSCAPE AND IRRIGATION IN AND AROUND THE PARKING LOT
- FENCING AND GATES
- ENTRY MONUMENTS

THE WORK LISTED ABOVE AS N.I.C. SHALL BE INCLUDED IN THE CLUBHOUSE PACKAGE AS INDICATED ON THE FOLLOWING PLANS.

SCOPE OF SITE WORK SUMMARY: CLUBHOUSE PACKAGE

THE SITE WORK INCLUDED IN THE CLUBHOUSE PACKAGE IS AS SHOWN ON THE FOLLOWING PLANS AND INCLUDES THE FOLLOWING WORK TO BE PERFORMED AT THE EXISTING PARKING:

- FINE GRADING AROUND THE PERIMETER OF THE PARKING LOT
- CONCRETE MOW EDGES AT LANDSCAPE BEDS
- LANDSCAPE BED AND ISLAND PREPARATION
- LANDSCAPE AND IRRIGATION IN AND AROUND THE PARKING LOT
- FENCING AND GATES
- ENTRY MONUMENTS

THE CLUBHOUSE PACKAGE CONTRACTOR SHALL COORDINATE WITH THE PARKING LOT PACKAGE CONTRACTOR AND OWNER TO THE INTO PREVIOUS WORK AT THE PARKING LOT AND THE GOLF COURSE.

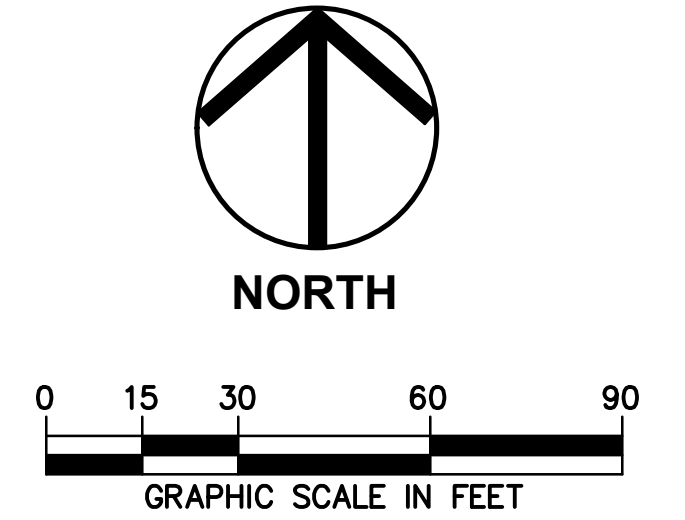
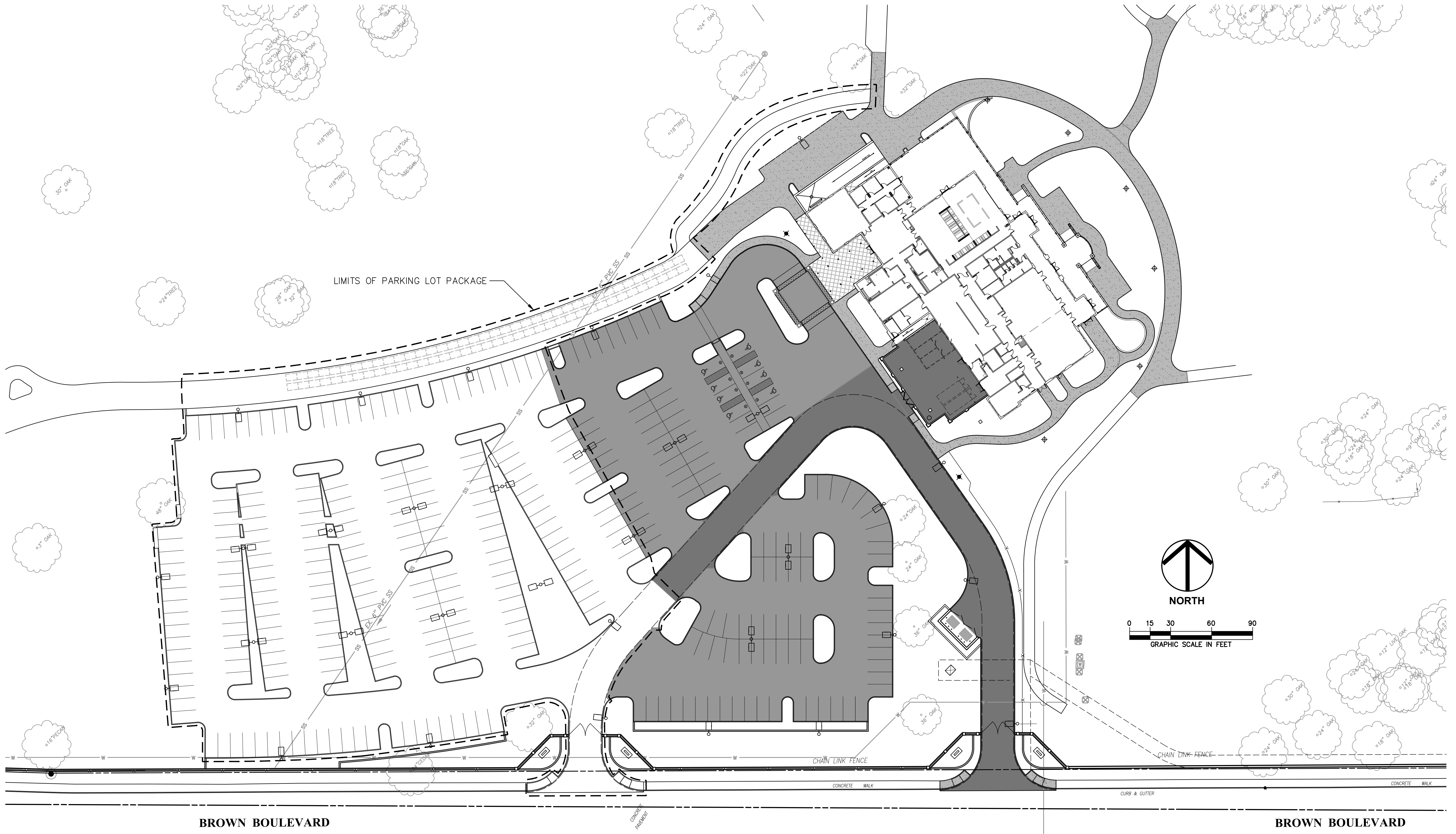

Civil Engineer
 SCHRIKKE, ROLLINS
 AND ASSOCIATES, INC.
 1161 CORPORATE DRIVE WEST
 SUITE 200
 ARLINGTON, TEXAS 76008
 P: 817.649.3216

**Mechanical, Electrical,
 Plumbing Engineer**
 MEP SYSTEMS
 916 DRAGON STREET
 DALLAS, TEXAS 75207
 P: 214.915.0929

Structural Engineer
 RONALD A. ROBERTS ASSOCIATES, INC.
 735 WARD DR.
 2948 N. STEMMONS FREEWAY
 DALLAS, TEXAS 75247
 P: 214.637.6299

Kitchen Consultant
 PROFITABLE FOOD FACILITIES
 14026 DONORT DRIVE
 POWAY, CALIFORNIA 92064
 P: 858.748.7333

A/V Consultant
 ACHEIVE AV, INC.
 735 WARD DR.
 CEDAR HILL, TEXAS 75104
 P: 214.884.5951



No.	Date
Revisions	
Project No.	21538.00
Drawn	-CH -XT -MW -HP
Checked	-MDS
Approved	
Key:	

CONSTRUCTION DOCUMENTS

Title:
SITE WORK SCOPE SUMMARY

Drawing No.
C1.00

Issue Date
 OCTOBER 25, 2017

© COPYRIGHT REES ASSOCIATES, INC. 2017
 SRA PROJECT #5311