



ARCHITECT
5G Studio Collaborative, LLC.
800 Jackson St., Suite 500
Dallas, TX 75202
Ian Meana 214-646-1508

STRUCTURAL ENGINEER
Hunt & Joiner, Inc.
1120 Capitol of Texas Highway Suite 100
Austin, TX 78746
Cole Edwards 512-358-8788

MEP ENGINEER
Envirodesign
900 Ranch Road 620 South, Suite C101-301
Austin, TX 78734
Sam Patton 512-693-9015

CIVIL ENGINEER
Maverick Engineering
1909 West Wall Street, Suite K
Midland, TX 79701
Andrew Melton 432-282-0999

OWNER
Cinergy Cinemas & Entertainment
5720 LBJ Freeway, Suite 625
Dallas, TX 75240
Jeffrey Benson 469-804-7475

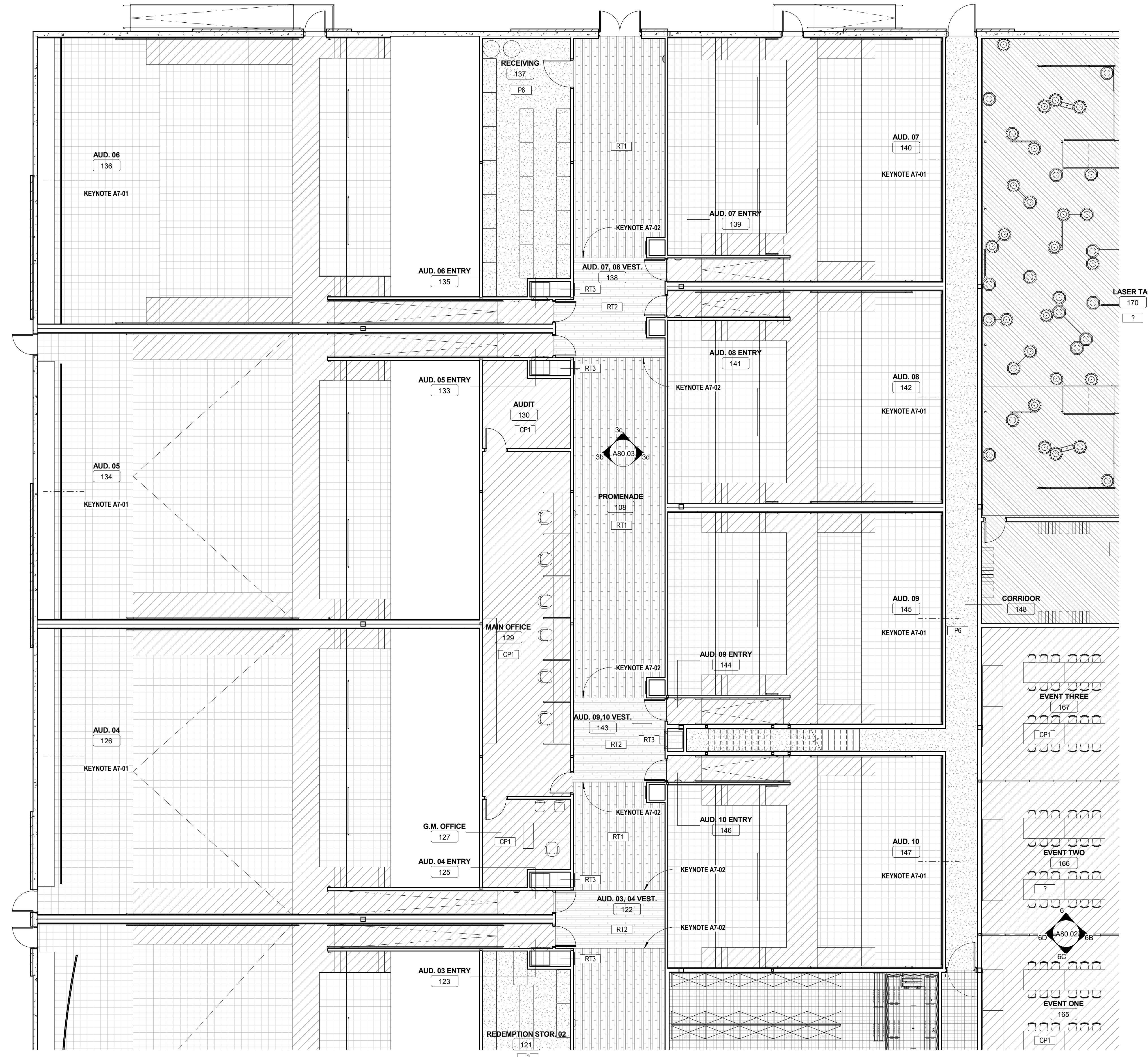

- A7-01 REFER TO MEZZANINE FINISH PLAN FOR AUDITORIUM FINISH INFORMATION.
- A7-02 ALIGN TILE WITH FACE OF WALL.
- A7-03 INSTALL ROW INDICATOR PER [6 / A90.01]
- A7-04 START INSTALLATION OF TILE AT EDGE OF SLAB. INSTALL BLACK CAULK ALONG EDGE OF FINISH AT LEADING EDGE AND BACK CORNER OF RISERS
- A7-05 DO NOT SEAL CONCRETE UNDER BOWLING LANES
- A7-06 INSTALL GAME FLOOR TILE PER [3 / A90.10]
- A7-07 INSTALL BASE 'B' AT PERIMETER OF TOP RISER
- A7-08 INSTALL BASE 'B' AT FACE OF WALL ONLY WHERE ACOUSTICAL WALL COVERING INTERSECTS VINYL FLOORING
- A7-09 INSTALL ALUMINUM SADDLE AT LANE TRANSITION PER [10 / A90.10]

2 KEYNOTES
12" = 1'-0"

- A PROVIDE TRANSITIONS AT DISSIMILAR FLOOR FINISHES PER [2 / A90.10]
- B ALL FINISHES SPECIFIED ARE CLASS 'A'.
- C RUBBER BASE IS TO HAVE PREFORMED CORNERS AND TO BE MITERED AT INSIDE CORNERS.
- D DO NOT WRAP RUBBER BASE AROUND OUTSIDE CORNERS OR BEND INTO INSIDE CORNERS.
- E PAINT SURFACES TO MATCH APPROVED SAMPLE. THIS MAY REQUIRE THREE OR MORE COATS OF PAINT.
- F ALL SEALANTS SHALL MATCH THE COLOR OF THE FINISH MATERIAL IN THE SAME PLANE.
- G NO VINYL OR ACOUSTICAL WALL COVERING EDGES ARE TO BE LEFT EXPOSED.
- H WRAP VINYL CONTINUOUSLY OVER ALL OUTSIDE CORNERS.
- I PROVIDE SMOOTH WALL SURFACE AT ALL WALLS THAT RECEIVE ACOUSTICAL WALL COVERING.
- J NEATLY CUT AND DRILL OPENINGS REQUIRED FOR CONDUIT, RECEPTACLES AND WIRING IN MILLWORK.
- K INSTALL 3/8" PLYWOOD TO 8'-0" AFF WITH SMOOTH SIDE OUT. COVER PLYWOOD IN THICK PRIMER AND PAINT SHERWIN WILLIAMS COLOR TO BE SELECTED BY VENDOR. CONTRACTOR IS RESPONSIBLE FOR INSTALLING DRYWALL, PROTECTION WALL, PRIMING AND PAINTING.

1 GENERAL NOTES
12" = 1'-0"

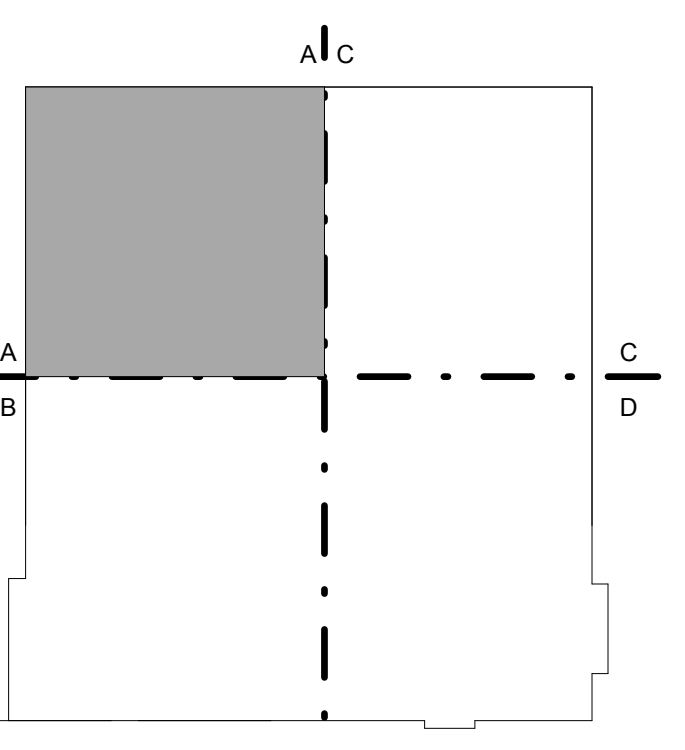

KEY PLAN

REV.	DATE	ISSUE TITLE
	05.12.17	ISSUE FOR PERMIT
	05.24.17	ISSUE FOR BID



CINERGY AMARILLO

LEVEL 1 FINISH PLAN
AREA 'A'

A70.01a
SHEET NUMBER

ARA007 PROJECT NUMBER

3 LEVEL 1 FINISH FLOOR PLAN AREA 'A'
1/8" = 1'-0"

