

PLANTING NOTES

- ALL PLANTS MUST BE HEALTHY, VIGOROUS MATERIAL, FREE OF PESTS AND DISEASE.
- ALL PLANTS MUST BE CONTAINER GROWN OR BALLED OR BURLAPPED AS INDICATED IN THE PLANT LIST.
- ALL TREES TO HAVE STRAIGHT CENTRAL LEAD TRUNK AND FULL, EVEN CANOPY. BEAD BRANCHES SHOULD BE PRUNED FROM TREE AFTER INSTALLATION.
- ALL PLANTS ARE SUBJECT TO THE APPROVAL OF THE OWNER'S REPRESENTATIVE BEFORE, DURING AND AFTER INSTALLATION.
- ALL TREES MUST BE GUYED OR STAKED AS SHOWN IN THE DETAILS.
- ALL PLANTING AREAS TO BE MULCHED WITH MATERIAL AND DEPTH AS SHOWN IN THE PLANS AND MATERIALS SCHEDULE.
- LOCATIONS OF EXISTING BURIED UTILITY LINES SHOWN ON THE PLANS ARE BASED UPON BEST AVAILABLE INFORMATION AND ARE TO BE CONSIDERED APPROXIMATE.
- PRIOR TO CONSTRUCTION, THE CONTRACTOR SHALL LOCATE ALL UNDERGROUND UTILITIES AND SHALL PROTECT ALL UTILITIES DURING THE COURSE OF THE WORK. THE CONTRACTOR IS RESPONSIBLE FOR REPAIRING ANY AND ALL DAMAGE TO THE UTILITIES, STRUCTURES, SITE APPURTENANCES, ETC., THAT OCCURS AS A RESULT OF THE LANDSCAPE CONSTRUCTION.
- ALL PLANT MATERIAL QUANTITIES WHERE HATCHES ARE SHOWN ARE APPROXIMATE. CONTRACTOR SHALL BE RESPONSIBLE FOR COMPLETE COVERAGE OF ALL PLANTING BEDS AT SPACING SHOWN.
- ALL QUANTITIES SHOWN ON PLANS TO BE VERIFIED BY LANDSCAPE CONTRACTOR PRIOR TO BIDDING AND INSTALLATION. LANDSCAPE CONTRACTOR SHALL BE RESPONSIBLE FOR INSTALLING ALL PLANT MATERIAL SHOWN ON PLANS.
- THE CONTRACTOR IS RESPONSIBLE FOR FULLY MAINTAINING ALL PLANTING, INCLUDING BUT NOT LIMITED TO: WATERING, MOWING, EDGING, SPRAYING, MULCHING, WEEDING, FERTILIZING, ETC. OF THE PLANTING AREAS AND LAWN UNTIL THE WORK IS ACCEPTED IN TOTAL BY THE OWNER.
- THE CONTRACTOR SHALL COMPLETELY GUARANTEE ALL PLANT MATERIAL FOR A PERIOD OF ONE (1) YEAR BEGINNING ON THE DATE OF TOTAL ACCEPTANCE. THE CONTRACTOR SHALL PROMPTLY MAKE ALL REPLACEMENTS BEFORE OR AT THE END OF THE GUARANTEE PERIOD.
- ANY PLANT MATERIAL WHICH DIES, TURNS BROWN, OR DEFOOLIATES PRIOR TO TOTAL ACCEPTANCE OF THE WORK SHALL BE PROMPTLY REMOVED FROM THE SITE AND REPLACED WITH MATERIAL OF THE SAME SPECIES, QUANTITY, AND SIZE. THE REPLACEMENT MATERIAL SHALL MEET ALL PLANT LIST SPECIFICATIONS.
- STANDARDS SET FORTH IN THE "AMERICAN STANDARD FOR NURSERY STOCK" REPRESENT GUIDELINE SPECIFICATIONS ONLY AND SHALL CONSTITUTE MINIMUM QUALITY REQUIREMENTS FOR PLANT MATERIAL.
- SAFE, CLEARLY MARKED PEDESTRIAN AND VEHICULAR ACCESS TO ALL ADJACENT PROPERTIES MUST BE MAINTAINED THROUGHOUT THE CONSTRUCTION PROCESS.
- THE CONTRACTOR IS CAUTIONED THAT LOCAL CITY STANDARDS MAY DIFFER FROM THOSE SHOWN HEREIN. CONSTRUCTION IS TO BE PERFORMED IN ACCORDANCE WITH LOCAL, CITY, STATE OR FEDERAL SPECIFICATIONS AND DETAILS SHOULD BE MORE STRINGENT THAN THOSE REPRESENTED HEREIN.
- STEEL EDGING SHALL BE INSTALLED AT ALL INTERFACES BETWEEN TURFGRASS (SOD OR SEED) AND MULCH MATERIALS, AND BETWEEN ORGANIC AND INORGANIC MULCHES.
- IF LANDSCAPE CONTRACTOR DEMONSTRATES THAT ALL KNOWN RESOURCES HAVE BEEN EXHAUSTED FOR SPECIFIED PLANT MATERIAL AND AVAILABILITY OR QUALITY DOES NOT MEET OR EXCEED CRITERIA, CONTACT OWNER'S REPRESENTATIVE FOR ALTERNATIVE PLANT MATERIAL POSSIBILITIES.
- PLANTING MATERIALS
 - COMPOST:
 - "COTTON BURR COMPOST" AS AVAILABLE FROM BACK TO NATURE, INC., SLATON, TX (888)282-2000
 - MYCORRHIZAL SUPPLEMENT:
 - "DIEHARD-TRANSPLANT," BY HORTICULTURAL ALLIANCE, INC. (800)628-6377. WWW.HORTICULTURALALLIANCE.COM. APPLY TO ALL PLANTINGS DURING THE PLANTING OPERATION AT THE RATES SPECIFIED BY THE MANUFACTURER. THE CONTRACTOR SHALL CALCULATE THE REQUIRED AMOUNT OF "DIEHARD TRANSPLANT," FOR THE PROJECT, USING THE MANUFACTURER'S SPREADSHEET.
 - MULCH:
 - DOUBLE-SHREDDED CEDAR MULCH, FREE FROM LITTER, DEBRIS, AND WEEDS.
 - WEED BARRIER FABRIC:
 - DEWITT PRO-5 PREMIUM LANDSCAPE FABRIC OR APPROVED EQUAL. (800)888-9669
- IN ALL AREAS TO RECEIVE LANDSCAPE INSTALLATION, TOPSOIL SHALL BE FREE FROM STONES, ROOTS, CLODS, CONCRETE, BASE, CALICHE, CONSTRUCTION DEBRIS, AND ANY OTHER FOREIGN MATERIAL NOT BENEFICIAL FOR PLANT GROWTH.
- IN TREE AND SHRUB PLANTINGS, AMEND EXISTING SOIL WITH 3" COMPOST AND TILL TO A MINIMUM DEPTH OF 12". AMEND TILLED SOIL WITH MYCORRHIZAL SUPPLEMENT PRIOR TO PLANTING.

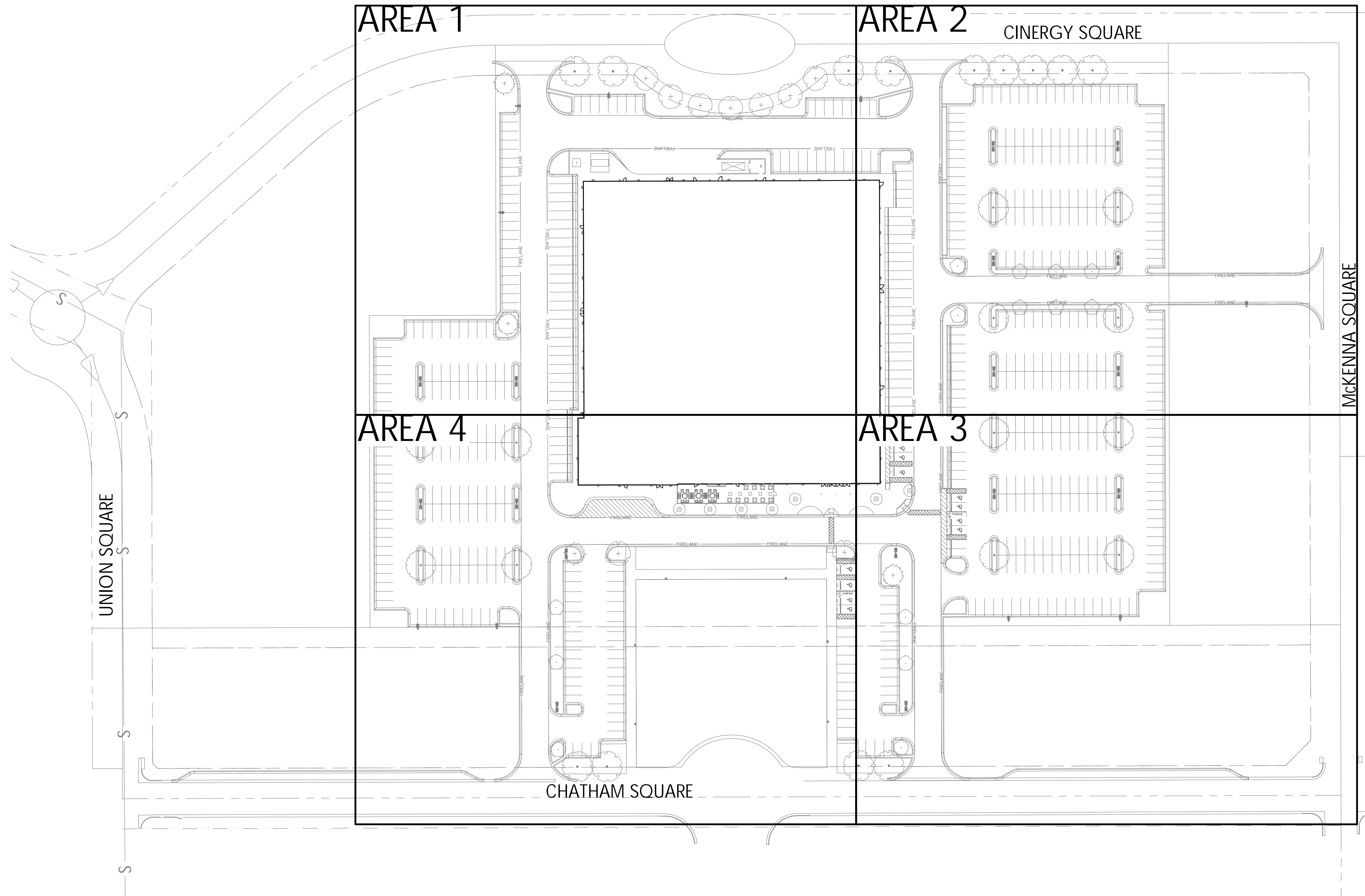

GRASS SODDING NOTES

- ALL SOD SHALL BE ALL SOD SHALL BE SPECIES AND VARIETY SPECIFIED IN PLANT MATERIALS SCHEDULE, FREE FROM WEEDS, THATCH, AND DISEASE.
- OVERSEEDING - FOR ANY SOD LAID BETWEEN SEPT. 15 THRU APRIL 15, HAND OVERSEED ANNUAL RYE AT 10 LBS./1000 S.F. FOR ALL SODDED AREAS SHOWN ON PLAN.
- FOR ALL TURFGRASS AREAS, EXISTING SOIL SHALL BE AMENDED WITH 1" COMPOST TILLED TO A DEPTH OF 4".
- PROVIDE TEMPORARY IRRIGATION AS NEEDED UNTIL A HEALTHY STAND OF GRASS IS ESTABLISHED OR UNTIL PERMANENT IRRIGATION IS FUNCTIONAL.

IRRIGATION NOTES

- ALL PLANTED AREAS SHALL BE WATERED WITH AN UNDERGROUND IRRIGATION SYSTEM. THE IRRIGATION SYSTEM SHALL BE AUTOMATICALLY CONTROLLED WITH A FULLY PROGRAMMABLE ET BASED CONTROLLER WITH RAIN AND FREEZE SENSORS.
- THE IRRIGATION SYSTEM AND INSTALLATION SHALL MEET ALL OF THE APPROPRIATE REQUIREMENTS OF THE LOCAL MUNICIPALITY.

CITY OF AMARILLO REQUIREMENTS

GROSS LOT AREA	426,736 SF	
BUILDING FOOTPRINT	89,840 SF	
	REQUIRED	PROVIDED
LANDSCAPE 10% OF BUILDING FOOTPRINT FOR EACH FRONTAGE		
89,840 SF X 10% = 8,984 SF		
8,984 SF. X 2 FRONTAGES	17,968 SF.	51,172
NON-LIVING LANDSCAPE NOT TO EXCEED 50% OF REQUIRED LANDSCAPE		
LIVING LANDSCAPE	8,984 SF.	24,518 SF.
NON-LIVING LANDSCAPE	8,984 SF.	26,518 SF.
STREET TREES		
1 TREE PER 40 LF OF STREET FRONTAGE		
CHATHAM 146' / 40 LF.	4	4
CINERGY 671' / 40 LF.	17	17
PARKING LOT TREES		
1 TREE PER 20 SPACES		
628 / 20	31	31

LANDSCAPE POINTS

POINTS	AWARDED FOR	CLAIMED
15	75% OF PLANT MATERIALS ARE WATER EFFICIENT	15
2	REQUIRED TREES >= 3" CALIPER	2
5	PARKING ISLAND >= 4" SF PER TREE	5
2	NON-LIVING LANDSCAPE MATERIAL & WEED BARRIER IN AREAS 4' WIDE OR LESS	1
5	PRESERVE EXISTING HEALTHY TREES 2" CALIPER OR GREATER	1
10	SUBSURFACE IRRIGATION FOR ALL TURF GRASS	1
5	D RIP IRRIGATION SYSTEMS WITHIN PLANTING BEDS	5
2	LANDSCAPE PLAN SEALED BY REGISTERED LANDSCAPE ARCHITECT	2
2	WEED BARRIER INSTALLED IN PLANTING BEDS	2
2	LANDSCAPE AREA EXCEEDS REQUIREMENT BY 10%	1
2	PARKING LOT TREE INSTALLATION ABOVE REQUIRED	1
2	ROOT BARRIERS USED TO PREVENT HARDSCAPE DAMAGE	1
	POINTS REQUIRED 20	TOTAL POINTS CLAIMED 31

LANDSCAPE POINTS DEDUCTIONS

POINTS	DEDUCTED FOR	DEDUCTIONS
15	MORE THAN 50% TOTAL REQUIRED LANDSCAPE AREA IS COOL SEASON GRASS	-
2	PLANTING OF TREE NOT LISTED ON RECOMMENDED PLANT LIST	-
	TOTAL POINTS CLAIMED	0

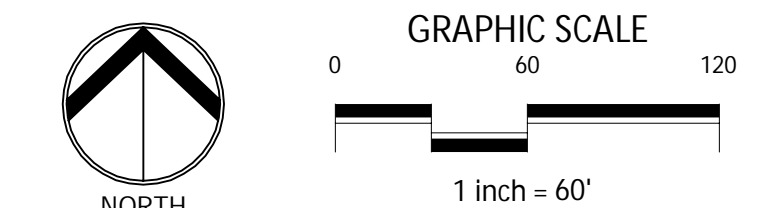

NO.	DATE	DESCRIPTION
1	5/18/2017	FOR BIDDING

OVERALL PLANTING PLAN

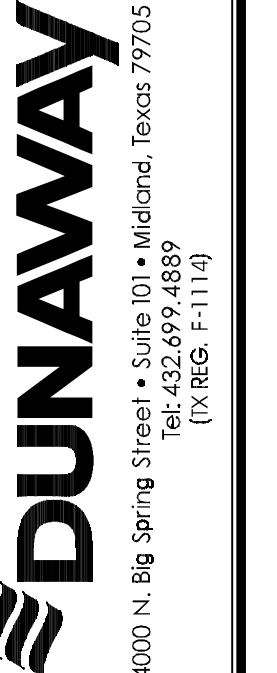

CINERGY CINEMAS
AMARILLO, TEXAS

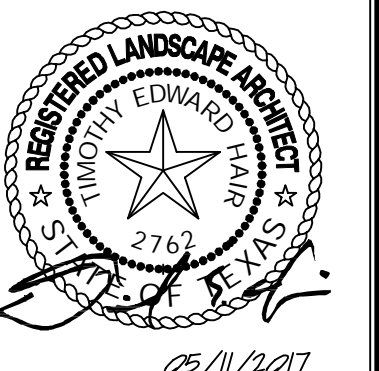

JOB NO:	B003373.001
DESIGNED BY:	TEH
DRAWN BY:	JEJ
CHECKED BY:	TEH
DATE:	MAY 19, 2017

SHEET: L1.00