

STANDARD CONSTRUCTION NOTES:

- CONTRACTOR TO VERIFY ALL EXISTING UTILITY TIE-IN CONNECTIONS AND VERIFY LOCATION AND ELEVATION PRIOR TO CONSTRUCTION.
- CONTRACTOR TO BUILD SEWER FROM TIE-IN POINT (A.K.A. DOWNHILL) AND PROCEED UPHILL.
- CITY OF AMARILLO TO BE NOTIFIED 48 HOURS BEFORE ANY CONSTRUCTION BEGINS.
- PIPE DEFLECTION PER MANUFACTURER'S RECOMMENDATIONS.
- ALL UTILITIES TO BE INSTALLED PER TEXAS ADMINISTRATIVE CODE (TAC) STANDARD SEPARATION SPECIFICATIONS.
- A TWO (2) FOOT MINIMUM VERTICAL SEPARATION SHALL BE PROVIDED BETWEEN ANY SEWER MAIN/LINE CROSSING A WATER MAIN/LINE.
- EXCEPTIONS OR DEVIATIONS FROM THE ABOVE MINIMUM CLEARANCES MUST BE APPROVED AND SHOWN ON THE APPROVED WATER AND SEWER PLANS. WHEN UTILITY CONFLICTS ARE FOUND DURING CONSTRUCTION, ALL CHANGES AND REVISIONS MUST BE PRECEDED BY AN APPROVED PLAN REVISION.
- ANY AND ALL MORE STRINGENT REQUIREMENTS REQUITED BY FEDERAL, STATE, COUNTY OR LOCAL CODES OR ORDINANCES TAKE PRECEDENCE.
- ALL CONSTRUCTION IN CITY OF AMARILLO RIGHT OF WAY TO CONFORM TO THE CITY OF AMARILLO STANDARDS
- ALL CONSTRUCTION ON SITE SHALL CONFORM TO MAVERICK ENGINEERING NOTES AND DETAIL SHEETS.
- CONCRETE OR ASPHALT DAMAGED DURING THE COURSE OF CONSTRUCTION SHALL BE REMOVED AND REPLACED IN KIND PRIOR TO FINAL INSPECTION.
- SANITARY SEWER SHALL BE PVC-SDR-35 UNLESS OTHERWISE NOTED.
- WATER SHALL BE C-900 PVC PIPE UNLESS OTHERWISE NOTED.
- THE CONTRACTOR SHALL PROVIDED ALL THRUST BLOCKING AT ALL FITTINGS AND BENDS AS REQUIRED IN ACCORDANCE TO DETAILS IN THE CITY OF MIDLANDS' DESIGN & CONSTRUCTION STANDARDS. THE CONTRACTOR WILL BE RESPONSIBLE FOR KEEPING EXISTING WATER MAINS IN SERVICE DURING CONSTRUCTION.

WATER NOTES:

- SEE M.E.P. PLANS FOR CONTINUATION.
- CONSTRUCT 3" DIAMETER WATER SERVICE LINE AS SHOWN. LENGTH OF LINE PER PLANS. C-900 PVC OR APPROVED EQUAL.
- INSTALL 3" WATER METER SERVICE CONNECTION PER STANDARD WATER DETAILS OF THE CITY OF AMARILLO STANDARD CONSTRUCTION DETAILS, INCLUDED ON SHEET C303 OF THIS PLANS SET.
- INSTALL 2" IRRIGATION METER SERVICE CONNECTION PER STANDARD WATER DETAILS OF THE CITY OF AMARILLO STANDARD CONSTRUCTION DETAILS, INCLUDED ON SHEET C303 OF THIS PLANS SET.
- CONSTRUCT 6" DIAMETER DUCTILE IRON PIPE FIRE LINE AS SHOWN. LENGTH OF LINE PER PLANS. BEDDING PER DRAWING STANDARD WATER DETAILS OF THE CITY OF AMARILLO STANDARD CONSTRUCTION DETAILS, INCLUDED ON SHEET C303 OF THIS PLANS SET.
- INSTALL FIRE HYDRANT WITH 6" GATE VALVE PER STANDARD WATER DETAILS OF THE CITY OF AMARILLO STANDARD CONSTRUCTION DETAILS, INCLUDED ON SHEET C303 OF THIS PLANS SET.
- INSTALL BEND PER PLAN AND THRUST BLOCK PER CITY OF AMARILLO STANDARD DETAIL 4, INCLUDED ON SHEET 303.
- CONSTRUCT 2" DIAMETER WATER SERVICE LINE AS SHOWN. LENGTH OF LINE PER PLANS. C-900 PVC OR APPROVED EQUAL.

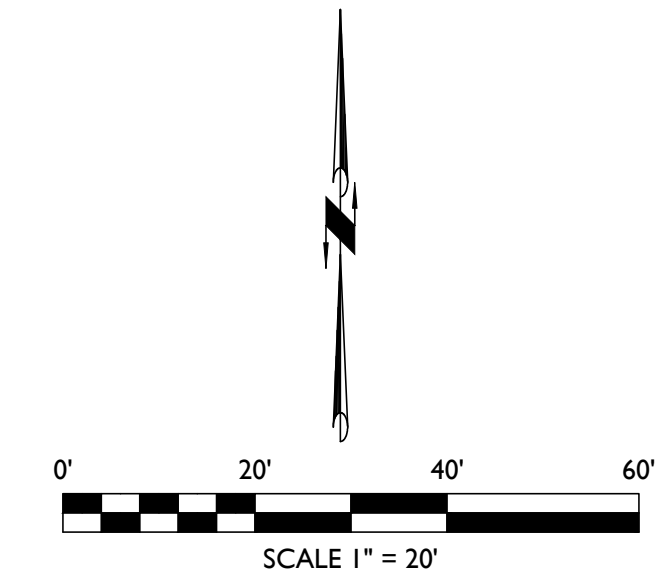
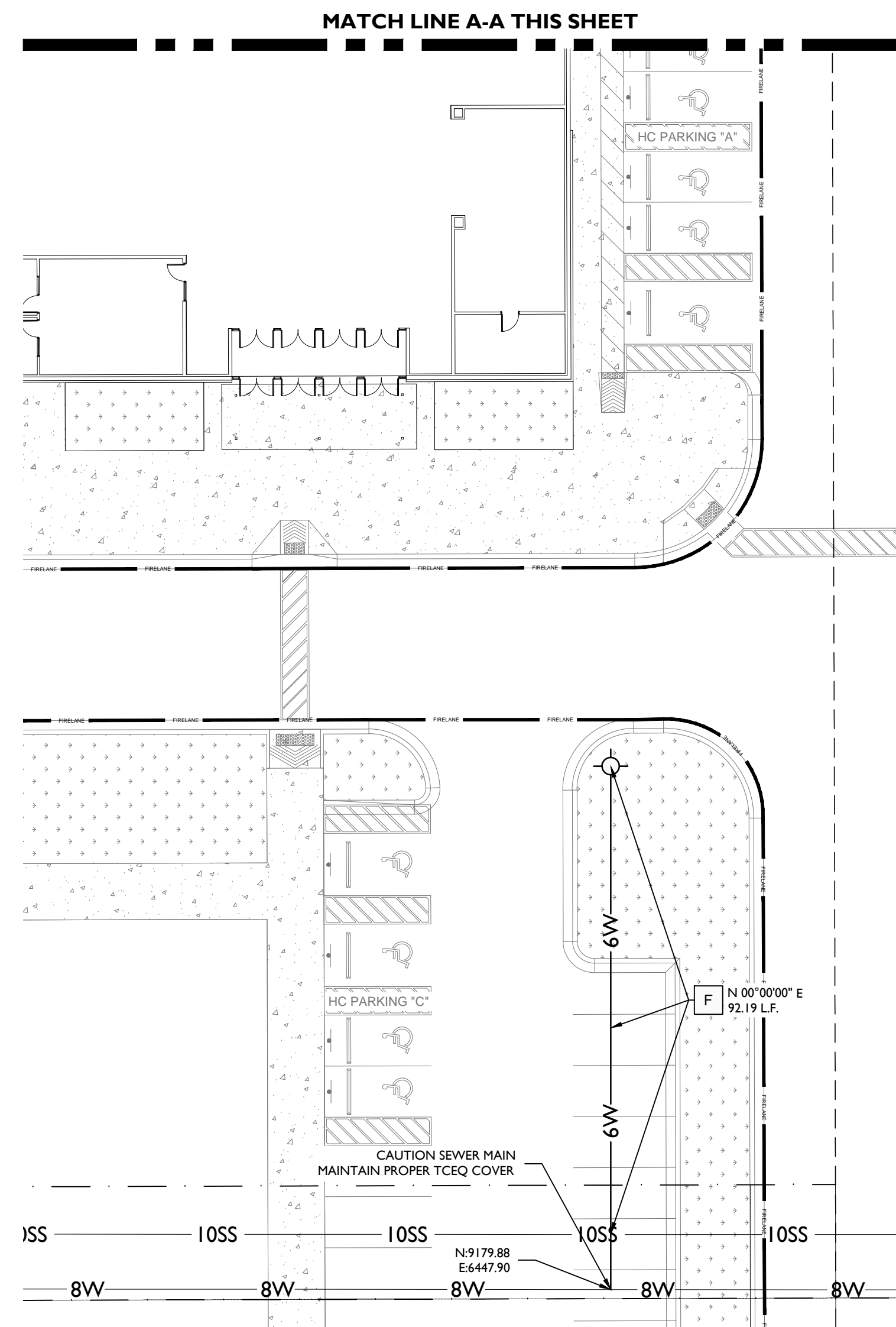

LEGEND

- ⊙ DENOTES SET 1/2-INCH IRON ROD
- ⊙ DENOTES FOUND MONUMENT AS NOTED
- ⊙ DENOTES EXISTING WATER METER
- ⊙ DENOTES EXISTING WATER VALVE
- ⊙ DENOTES EXISTING MANHOLE
- ⊙ DENOTES EXISTING GAS MARKER
- ⊙ DENOTES EXISTING BOUNDARY LINE
- ⊙ DENOTES BOUNDARY LINE
- ⊙ DENOTES EASEMENT LINE
- ⊙ DENOTES EXISTING CONTOURS
- S DENOTES EXISTING SEWER LINE
- 8SS DENOTES EXISTING 8" SEWER LINE
- 10SS DENOTES EXISTING 10" SEWER LINE
- 6W DENOTES EXISTING 6" WATER LINE
- 8W DENOTES EXISTING 8" WATER LINE
- 6SW DENOTES PROPOSED 6" SEWER LINE
- 3W DENOTES PROPOSED 3" WATER LINE
- 6W DENOTES PROPOSED 6" WATER LINE
- ⊙ DENOTES PROPOSED FIRE HYDRANT
- ⊙ DENOTES PROPOSED POST INDICATOR VALVE
- ⊙ DENOTES PROPOSED WATER METER
- ⊙ DENOTES PROPOSED WATER VALVE
- ⊙ DENOTES PROPOSED SEWER CLEANOUT
- ⊙ DENOTES PROPOSED SEWER MANHOLE

MAVERICK ENGINEERING
 1909 West Wall Street, Suite "K"
 Midland, Texas 79701 FIRM: F-15089
 Tel: (432) 262-0999 Fax: (432) 262-0989
 www.Maverick-Eng.com

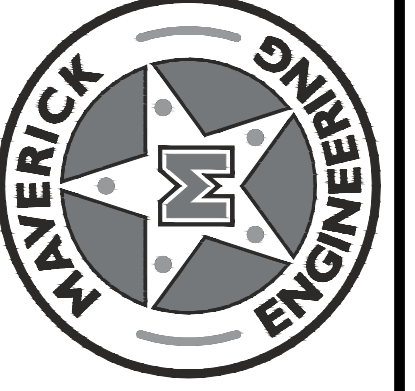

DATE	BY	REVISIONS

DRAWN BY: TDE	CHECKED BY: ALM	APPROVED BY: ALM	DATE: 04/14/2016	JOB: 2015-0071
---------------	-----------------	------------------	------------------	----------------

WATER PLANS
CINERGY CINEMAS
 BEING A 9.7 TRACT OUT OF LOT 2, BLOCK 2, SECTION 63, BS&F SURVEY, CITY OF AMARILLO, POTTER COUNTY, TEXAS.



Know what's below.
 Call before you dig.

Andrew L. Mellen
 106572
 LICENSED PROFESSIONAL ENGINEER
 03/09/2017
C301 OF 23