

© COPYRIGHT 2016 ALL RIGHTS RESERVED F:\3101515007\JEFF BENSON\CINERMA\AMARILLO\DRAWINGS\CIVIL\CONSTRUCTION SHEETS\15150071 C220 GRADING PLAN NW.DWG

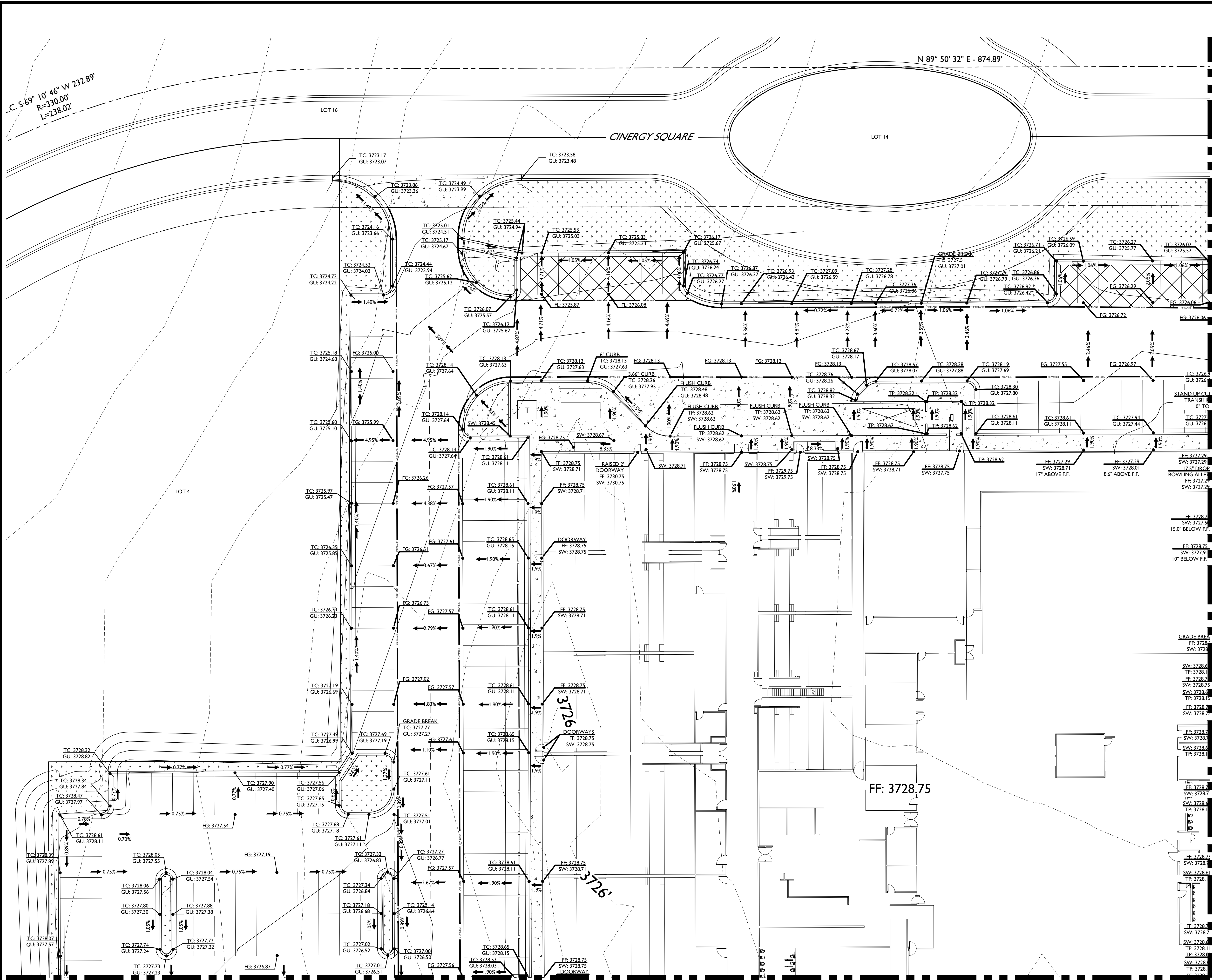

N 89° 50' 32" E - 874.89'

C. S 69° 10' 46" W 232.89'
R=330.00'
L=238.02'

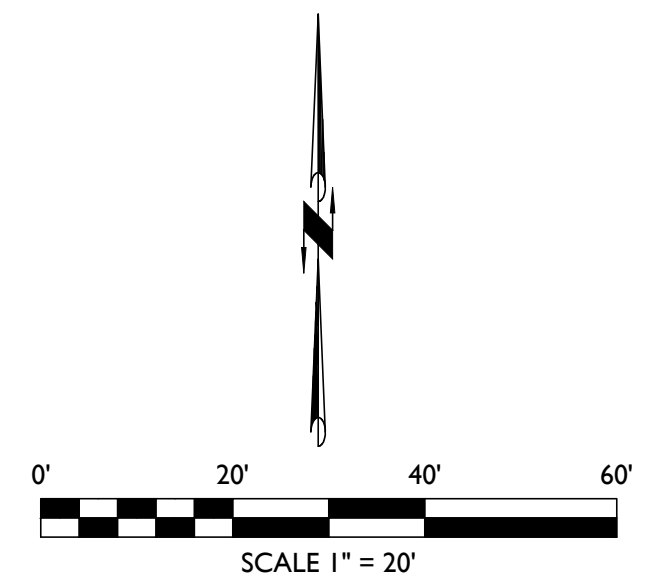

LEGEND

- ⊙ DENOTES SET 1/2-INCH IRON ROD
- ⊙ DENOTES FOUND MONUMENT AS NOTED
- ⊙ DENOTES EXISTING WATER METER
- ⊙ DENOTES EXISTING WATER VALVE
- ⊙ DENOTES EXISTING MANHOLE
- ⊙ DENOTES EXISTING GAS MARKER
- DENOTES BOUNDARY LINE
- - - DENOTES BOUNDARY LINE
- - - DENOTES EASEMENT LINE
- - - DENOTES EXISTING CONTOURS
- S DENOTES EXISTING SEWER LINE
- TC DENOTES TOP OF CURB
- GU DENOTES GUTTER
- FG DENOTES FINISHED GRADE
- G DENOTES GRADE
- FL DENOTES FLOW LINE
- EX DENOTES EXISTING
- FF DENOTES FINISHED FLOOR
- SW DENOTES SIDEWALK
- TP DENOTES TOP OF PAVEMENT
- TW DENOTES TOP OF WALL

MATCH LINE A-A SEE SHEET C221

MATCH LINE B-B SEE SHEET C223



Know what's below.
Call before you dig.

MAVERICK ENGINEERING
 1909 West Wall Street, Suite "K"
 Midland, Texas 79701 FIRM: F-15089
 Tel: (432) 262-0999 Fax: (432) 262-0989
 www.Maverick-Eng.com

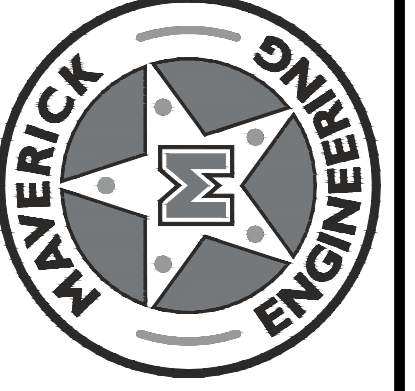

DATE	
BY	
APPR.	
REGIONS	
DRAWN BY:	TDE
CHECKED BY:	ALM
APPROVED BY:	ALM
DATE:	04/14/2016
JOB:	2015-0071

**GRADING PLAN NORTHWEST
CINERGY CINEMAS**
 BEING A 9.7 TRACT OUT OF LOT 2, BLOCK 2, SECTION 63, BS&F
 SURVEY, CITY OF AMARILLO, POTTER COUNTY, TEXAS.

811
 Know what's below.
 Call before you dig.

Andrew L. Mellen
 ANDREW L. MELLEN
 PROFESSIONAL ENGINEER
 03/09/2017

SHEET **C220** OF 23