

ARCHITECT
5G Studio Collaborative, LLC.
800 Jackson St., Suite 500
Austin, TX 75202
Ian Means 214-646-1508

STRUCTURAL ENGINEER
Hunt & Joiner, Inc.
1120 Capitol of Texas Highway Suite 100
Austin, TX 78746
Collin Edwards 512-358-8788

MEP ENGINEER
EnviroDesign
900 Ranch Road 620 South, Suite C101-301
Austin, TX 78734
Sam Patton 512-693-9015

CIVIL ENGINEER
Maverick Engineering
1909 West Wall Street, Suite K
Midland, TX 79701
Andrew Melton 432-262-0999

OWNER
Cinergy Cinemas & Entertainment
5720 LBJ Freeway, Suite 625
Dallas, TX 75240
Jeffrey Benson 469-804-7475

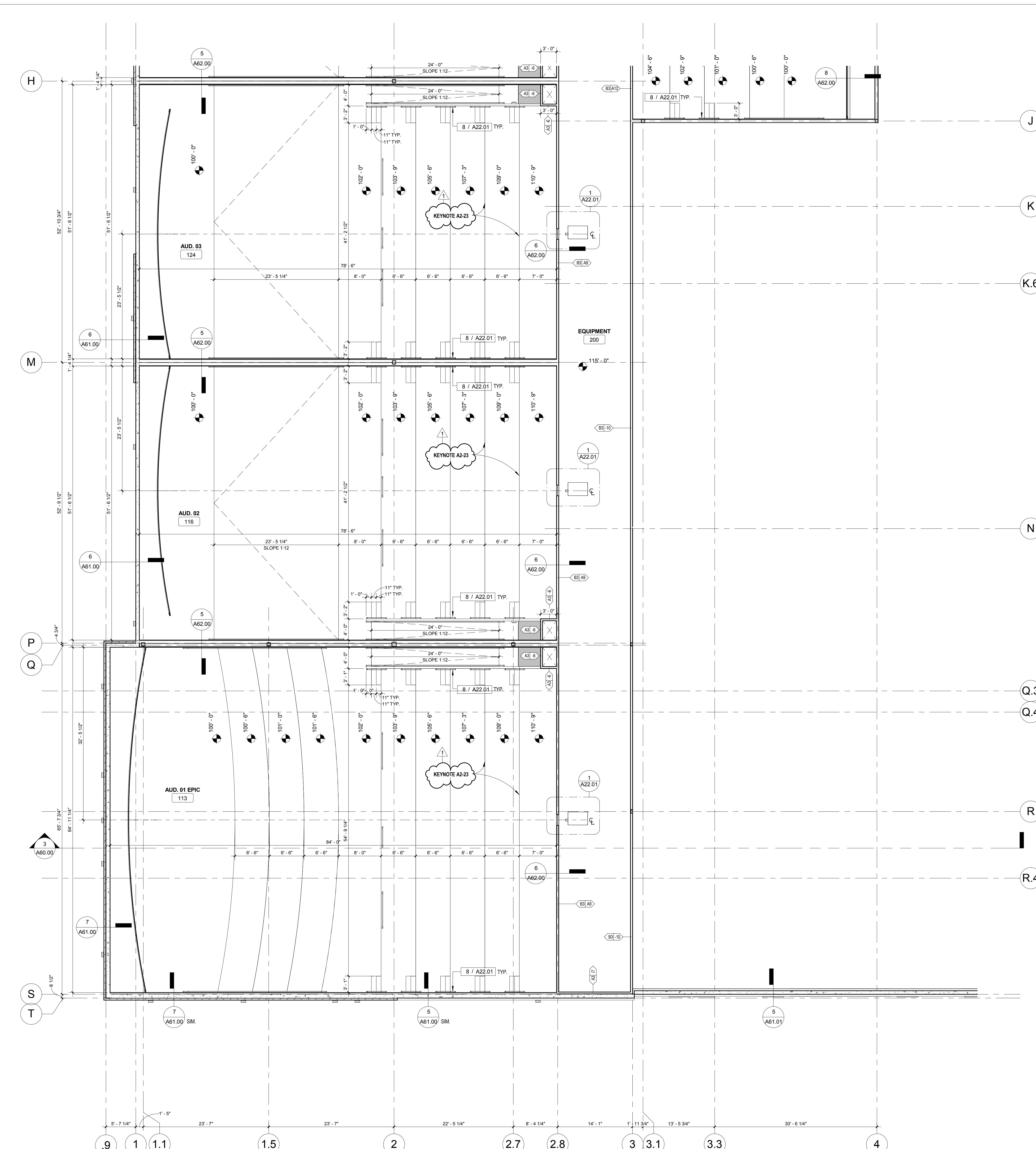

3 MEZZANINE FLOOR PLAN AREA 'C'
1/8" = 1'-0"

- A2-01** NO PENETRATIONS ALLOWED AT DEMISING WALLS.
- A2-02** INSTALL KNOX BOX ON THIS WALL. COORDINATE EXACT LOCATION WITH LOCAL AUTHORITIES. SUBMIT PRODUCT DATA FOR FIRE MARSHAL FOR REVIEW AND APPROVAL PRIOR TO INSTALLATION.
- A2-03** INSTALL ROOF ACCESS LADDER PER [2 / A20.31]
- A2-04** TICKET KIOSK BY VENDOR. PROVIDE POWER AND DATA PER ELECTRICAL.
- A2-05** GAME CARD KIOSK BY VENDOR. PROVIDE POWER AND DATA PER ELECTRICAL.
- A2-06** BILL BREAKER KIOSK BY VENDOR. PROVIDE POWER AND DATA PER ELECTRICAL.
- A2-07** MILLWORK BY VENDOR. COORDINATE ROUGH OPENING WITH VENDOR SHOP DRAWINGS AND PROVIDE BLOCKING, ELECTRICAL, AND PLUMBING AS REQUIRED.
- A2-09** TICKET TAKER PODIUM BY VENDOR. PROVIDE POWER AND DATA AS REQUIRED.
- A2-10** MULTILEVEL LASER TAG PLAYING FIELD SUPPLIED AND INSTALLED BY VENDOR.
- A2-11** LOCKER MILLWORK BY VENDOR.
- A2-12** LAINE CLEANER STORAGE RACK
- A2-13** BALL CLEANING MACHINE
- A2-14** INSTALL 4'-0" X 8'-0" PEG BOARD AT FACE OF WALL. COORDINATE EXACT LOCATION WITH OWNER.
- A2-15** DASHED LINE INDICATES LOCATION OF WOOD BUMPER PER [14 / A22.00]
- A2-16** INSTALL 4'-0" X 8'-0" PLYWOOD AT ENTIRE LENGTH OF WALL ABOVE PINSETTERS
- A2-17** INSTALL MASONITE TO 8'-0" AT PERIMETER OF ROOM. INSTALL T-MOLDING AT EACH JOINT AND PAINT P1
- A2-18** INSTALL 5/8" WATER RESISTANT GYPSUM BOARD AT FACE OF WALLS WITH PLUMBING PENETRATIONS. INSTALL PLYWOOD SHEATHING AT ALL NON-PLUMBING WALLS PER [22 / A22.00]
- A2-19** OIL SYSTEM PROVIDED AND INSTALLED BY VENDOR. INSTALL FILL BOX ON FACE OF EXTERIOR WALL AND COORDINATE PENETRATION FOR SYSTEM WITH VENDOR.
- A2-20** INSTALL CO2 FILL BOX FLUSH WITH FACE OF BRICK. COORDINATE EXACT DIMENSIONS WITH VENDOR.
- A2-21** RETURN BRICK VENEER AT END OF PANEL.
- A2-22** OPERABLE PARTITION POCKET
- A2-23** INSTALL RISER CLOSURE PER [15 / A22.01]
- 2 KEYNOTES**
1/2" = 1'-0"
- 01** FIELD VERIFY ALL DIMENSIONS PRIOR TO CONSTRUCTION AND NOTIFY ARCHITECT OF ANY DEVIATIONS.
- 02** DO NOT SCALE THE DRAWINGS.
- 03** ALL ELEVATIONS SHOWN ARE RELATIVE TO THE FINISH FLOOR ELEVATION OF 100'-0".
- 04** INTERIOR DIMENSIONS ARE FROM FACE OF GYPSUM BOARD TO FACE OF GYPSUM BOARD OR CONCRETE.
- 05** INSTALL HINGE SIDE OF HOLLOW METAL DOOR FRAMES 4" FROM ADJACENT FACE OF GYPSUM BOARD, U.N.O.
- 06** ELECTRICAL COVER PLATES IN CONCESSIONS, KITCHEN AND SCULLERY ARE TO BE STAINLESS STEEL. ALL OTHER ELECTRICAL COVER PLATES ARE TO BE BLACK.
- 07** CONTRACTOR SHALL PROVIDE WOOD BLOCKING AS REQUIRED TO SUPPORT ALL ITEMS HANGING OR MOUNTED TO WALL SURFACES INCLUDING BUT NOT LIMITED TO: HANDRAILS, TOILET AND JANITORIAL ACCESSORIES, MILLWORK, THEATER EQUIPMENT AND ACCESSORIES, TELEVISIONS AND SIGNAGE.
- 08** PROVIDE 12" X 12" ACCESS PANELS IN ALL PARTITIONS WHERE TRANSFORMERS, J-BOXES, PLUMBING VALVES, VARIABLE AIR BOXES, FTB BOXES, DAMPERS, SANITARY SEWER OR GREASE TRAPS REQUIRING ACCESS ARE LOCATED. THE CONTRACTOR IS RESPONSIBLE FOR DETERMINING THE EXACT QUANTITY AND LOCATION OF ACCESS PANELS. COORDINATE EXACT LOCATIONS WITH ARCHITECT TO MINIMIZE AESTHETIC IMPACT ON THE OVERALL DESIGN.
- 09** VENDOR WILL PROVIDE AND INSTALL A PERMANENT FOR EACH ASSEMBLY SPACE THAT INDICATES THE OCCUPANT LOAD OF THE SPACE. THE TOTAL OCCUPANCY OF THE BUILDING WILL BE SHOWN ON THE LOBBY PLACARD. VENDOR AND CONTRACTOR TO COORDINATE EXACT PLACEMENT OF PLACARDS WITH LOCAL AUTHORITIES.
- 10** SEE [3 / A22.01] FOR TYPICAL PANEL JOINT SEALANT DETAILS
- 11** GAMES AND FURNISHINGS SHOWN ON PLAN ARE PROVIDED AND INSTALLED BY OWNER'S VENDOR, U.N.O.
- 12** ELECTRICAL CONTRACTOR TO COORDINATE FINAL LOCATION OF GAME ROOM POWER DROPS WITH OWNER'S VENDOR. POWER TO BE SURFACE MOUNTED ON RIGID CONDUIT.
- 13** MILLWORK AND SHOWN EQUIPMENT IS SUPPLIED BY OWNER'S VENDORS.
- 14** REVIEW VENDORS SHOP DRAWINGS AND COORDINATE POWER, PLUMBING AND BLOCKING REQUIREMENTS FOR EQUIPMENT AND MILLWORK WITH VENDORS SHOP DRAWINGS, ELECTRICAL AND PLUMBING DRAWINGS.
- 15** SEE PLUMBING DRAWINGS FOR LOCATIONS OF FLOOR SINKS AND FLOOR DRAINS.
- 16** PROVIDE POSITIVE SLOPE TO ALL FLOOR DRAINS. SLOPE NOT TO EXCEED 2%.
- 17** INSTALL TRASH GUARD AT ALL RISERS PER [17 / A22.00]
- 18** GAME AND FURNITURE LOCATIONS ARE SHOWN ONLY TO BE REPRESENTATIVE. ACTUAL LOCATION TO BE DETERMINED AT INSTALLATION
- 1 GENERAL NOTES**
1/2" = 1'-0"

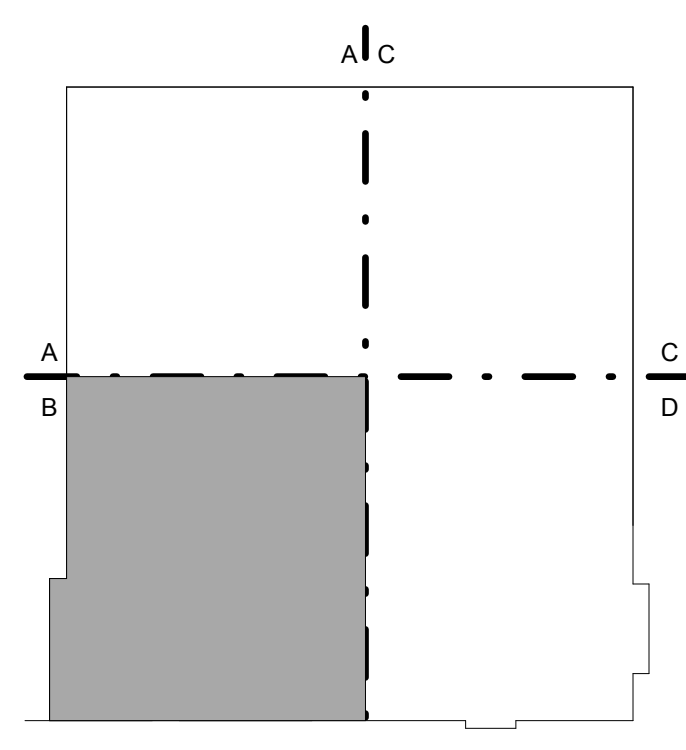

KEY PLAN

REV.	DATE	ISSUE TITLE
	05.12.17	ISSUE FOR PERMIT
	05.24.17	ISSUE FOR BID
1	06.12.17	ADDENDUM 01

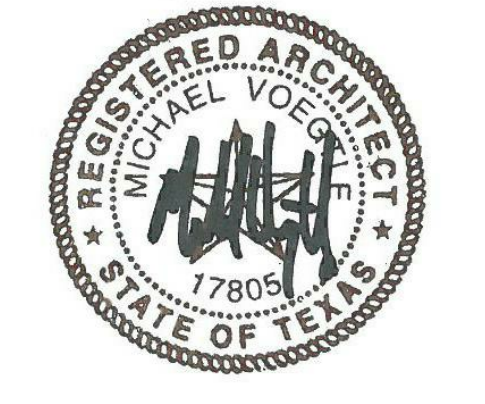

CINERGY AMARILLO

EQUIPMENT FLOOR
PLAN AREA 'B'

ARA007 PROJECT NUMBER **A20.02b** SHEET NUMBER

