

FILE: C:\PROJECTS\POD\POD1611 - Binnerr Church Remodel\Drawings\E115 - POD1611 - PH1.dwg
 SCALE: 48 DATE/TIME: Apr 13, 2017 11:26am
 USER: FOURPOINTMEP4.XREF(3); POD1611 - ARCH - TB.dwg
 PROJECT: POD1611 - ARCH - PH1.dwg
 DRAWING: PH1.dwg
 SHEET: E115
 DATE: 04.12.2017
 TIME: 11:26am

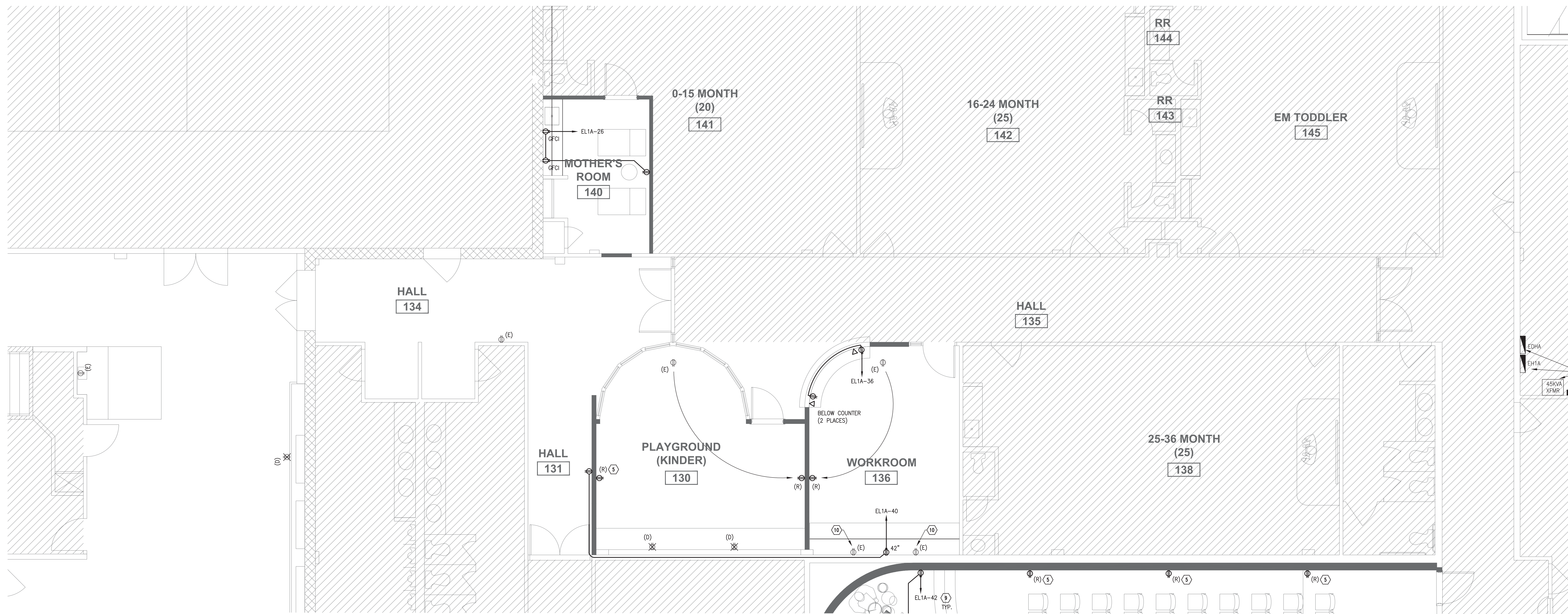

01 KINDER PLAYROOM / MOTHER'S ROOM ELECTRICAL POWER PLAN - LEVEL 1
1/4" = 1'-0"

ELECTRICAL SYMBOL LEGEND [PARTIAL]		
ALL SYMBOLS NOT NECESSARILY USED		
SYMBOL	DESCRIPTION	MOUNTING
⊕	SIMPLEX RECEPTACLE, NEMA 5-20R	18" AFF UNO
⊗ (D)	EXISTING RECEPTACLE TO BE DEMOLISHED (D) (LOCATION APPROX. FROM 1995 PLANS)	18" AFF UNO
⊕ (E)	EXISTING (E) RECEPTACLE TO REMAIN, U.N.O. (LOCATION APPROX. FROM 1995 PLANS)	18" AFF UNO
⊕ (R)	RELOCATED (R) RECEPTACLE (VERIFY COMPLIANCE WITH SPECS)	18" AFF UNO
⊕	DUPLEX RECEPTACLE, NEMA 5-20R	18" AFF UNO
⊕GFCI	DUPLEX RECEPTACLE, NEMA 5-20R, GFCI	18" AFF UNO
⊕IG	DUPLEX RECEPTACLE, NEMA 5-20R, ISOLATED GROUND	18" AFF UNO
⊕	QUAD RECEPTACLE, NEMA 5-20R	18" AFF UNO
⊕IG	QUAD RECEPTACLE, NEMA 5-20R, ISOLATED GROUND	18" AFF UNO
⊕GFCI	QUAD RECEPTACLE, NEMA 5-20R, GFCI	18" AFF UNO
⊕	WALL MOUNT SPECIAL PURPOSE RECEPTACLE	18" AFF UNO
⊕	SPECIAL PURPOSE RECEPTACLE	18" AFF UNO
⊕	FLUSH MOUNT DUPLEX RECEPTACLE	FLR/CLG AS NOTED ON PLANS
⊕	FLUSH MOUNT QUAD RECEPTACLE	FLR/CLG AS NOTED ON PLANS
⊕	POKE THRU DEVICE	FLOOR
⊕	FLOOR MOUNTED OR POKE THRU OUTLET FOR POWER & VOICE/DATA	FLOOR
⊕	JUNCTION BOX	AS RE: 'D
⊕	WALL MOUNTED JUNCTION BOX	AS RE: 'D
⊕	TELEPHONE OUTLET	AS RE: 'D
⊕	FLUSH MOUNT TELEPHONE OUTLET	FLR/CLG AS NOTED ON PLANS
⊕	COMBINATION TELEPHONE/DATA OUTLET	AS RE: 'D
⊕	FLUSH MOUNT TELEPHONE/DATA OUTLET	FLR/CLG AS NOTED ON PLANS
⊕	DATA OUTLET	AS RE: 'D
⊕	FLUSH MOUNT DATA OUTLET	FLR/CLG AS NOTED ON PLANS

NOTES:
 1. REFER TO SHEET E301 FOR COMPLETE LIST OF ELECTRICAL SYMBOLS.
 2. REFER TO ARCHITECTURAL PLANS FOR FULL EXTENT OF DEMOLITION.

EYNOTES "X"

NOTE: NOT ALL KEYNOTES APPEAR ON EVERY 1ST FLOOR POWER PLAN.

- VERIFY LOCATION, LOAD, AND TERMINATION REQUIREMENTS WITH THE FINAL AUDIO, VISUAL, & LIGHTING (AVL) PLANS.
- THERE ARE EXISTING RECEPTACLES IN AREA TO BE DEMOLISHED THAT ARE NOT SHOWN (REFER TO GENERAL NOTE "E", ORIGINAL 1995 PLANS, AND ARCHITECTURAL DEMO PLANS). IF THE RECEPTACLES ARE IN GOOD CONDITION, COMPLY WITH CODE, AND CAN BE WARRANTED FOR ONE YEAR, THEY MAY BE RELOCATED AND REUSED. PROVIDE NEW COVER-PLATE IF EXISTING IS DAMAGED OR CANNOT BE COMPLETELY CLEANED.
- REFERENCE AVL PLANS FOR ADDITIONAL, NEW BRANCH CIRCUITS IN AREA.
- FIELD VERIFY THAT DESIGNATED CIRCUIT IS NOT IN USE. DESIGNATION IS BASED ON 1995 PLANS (PORTIONS OF WHICH ARE ILLEGIBLE). MEASURE PEAK PANEL "EL1B" LOAD TO CONFIRM IT IS LESS THAN 140A. SEE ALSO PANEL SCHEDULE. CONTACT ARCHITECT OR ENGINEER FOR DIRECTION IF NECESSARY. (TYPICAL FOR ALL NEW CIRCUITS).
- EXISTING RECEPTACLES SHALL BE RELOCATED SLIGHTLY (APPROX. 12") FOR NEW WALL FINISH.
- VERIFY FINAL LOCATION AND REQUIREMENTS WITH AVL PLANS.
- DEMO (E) FLOOR RECEPTACLE AND REPAIR FLOOR.
- PROVIDE 277V POWER TO NEW EXHAUST FANS FROM LOCAL LIGHTING CIRCUIT WITH ON-OFF SWITCH ON WALL. FIELD VERIFY THAT RESULTING CIRCUIT LOAD WILL NOT EXCEED 15A. COORDINATE WITH MECHANICAL CONTRACTOR.
- FIELD VERIFY THAT DESIGNATED CIRCUIT IS NOT IN USE. DESIGNATION IS BASED ON 1995 PLANS (PORTIONS OF WHICH ARE ILLEGIBLE). MEASURE PEAK PANEL "EL1A" LOAD TO CONFIRM IT IS LESS THAN 100A. SEE ALSO PANEL SCHEDULE. CONTACT ARCHITECT OR ENGINEER FOR DIRECTION IF NECESSARY. (TYPICAL FOR ALL NEW CIRCUITS).
- RELOCATE (E) RECEPTACLES TO ABOVE LOWER CABINET IF NECESSARY.
- REWORK AND EXTEND EXISTING POWER TO RELOCATED VAV BOX. FIELD VERIFY EXISTING CONDITIONS AND COORDINATE WITH MECHANICAL CONTRACTOR.

INITIAL ELECTRICAL TESTING

EXISTING 120/208V PANELS WILL BE REUSED FOR RELOCATED AND NEW CIRCUITS. EXISTING 1995 PLANS ARE NOT LEGIBLE AND SOME REMODELS HAVE OCCURRED SINCE 1995. THERE ARE ALSO BREAKERS THAT ARE IDENTIFIED AS "SPARE" ON PANEL DIRECTORIES BUT ARE IN THE "ON" POSITION, SO ADDITIONAL UNKNOWN LOADS MAY EXIST.

THEREFORE, EXISTING TOTAL LOADS ON PANELS ARE UNKNOWN. ELECTRICAL CONTRACTOR SHALL FIELD VERIFY EXISTING CONDITIONS AND AVAILABLE CIRCUITS, SUCH AS AVAILABLE SPARES AND CIRCUITS/BREAKERS THAT ARE FREED UP FROM DEMOLITION, AND REPORT ANY SIGNIFICANT DISCREPANCIES AND/OR CONCERNS TO THE ARCHITECT AND ENGINEER.

EXISTING PANELS "EL1A", "EL2A", "EL2B", AND "SL2" SHALL BE MONITORED FOR A MINIMUM OF 30 DAYS WITH RECORDING-TYPE, 3-PHASE ELECTRICAL METERS BEFORE BEGINNING CONSTRUCTION. REPORT THE PEAK LOAD TO THE ENGINEER. SEE ALSO KEYNOTES FOR ADDITIONAL DETAILS.



041317
 The seal appearing on this document was authorized by M. BRYAN CHADWICK, License No. 96694, State of Texas, on 04/13/2017. Alteration of a sealed document without proper notification to the responsible engineer is an offense under the Texas Engineering Practice Act. The record copy of this document shall be filed in the office of the Professional Engineer at the office of FourPoint MEP, 931 N Edgfield Ave, Dallas, Texas 75208. P.E. #17995. TX Form #17995. Ph: (214) 635-4637.

BINNERRI PRESBYTERIAN CHURCH
RICHARDSON, TX
 1301 ABRAMS RD.
 ROCHARDSON, TEXAS 75081



COPYRIGHT THESE DRAWINGS ARE THE PROPERTY OF POOLE+DRENNAN DESIGN STUDIO AND SHALL NOT BE DUPLICATED, DISCLOSED OR REUSED WITHOUT THE WRITTEN CONSENT OF POOLE+DRENNAN DESIGN STUDIO

DRAWN BY: _____
 CHECKED BY: _____
 DATE: **04.12.2017**
 REVISIONS: _____
 PROJECT NO.: **16054**
 SHEET TITLE: **PHASE I- KINDER PLAY ELECTRICAL POWER PLAN**
 SHEET NO.: _____

E116

