

041317
The seal appearing on this document was authorized by TIM JENSEN, P.E. 74855 on 04-13-2017. Alteration of a sealed document without proper notification to the responsible engineer is an offense under the Texas Engineering Practice Act. The record copy of this drawing is on file at the office of FourPoint MEP, 16054 P.M.P. #17995.

BINNERRI PRESBYTERIAN CHURCH
RICHARDSON, TX
1301 ABRAMS RD.
ROCHARDSON, TEXAS 75081

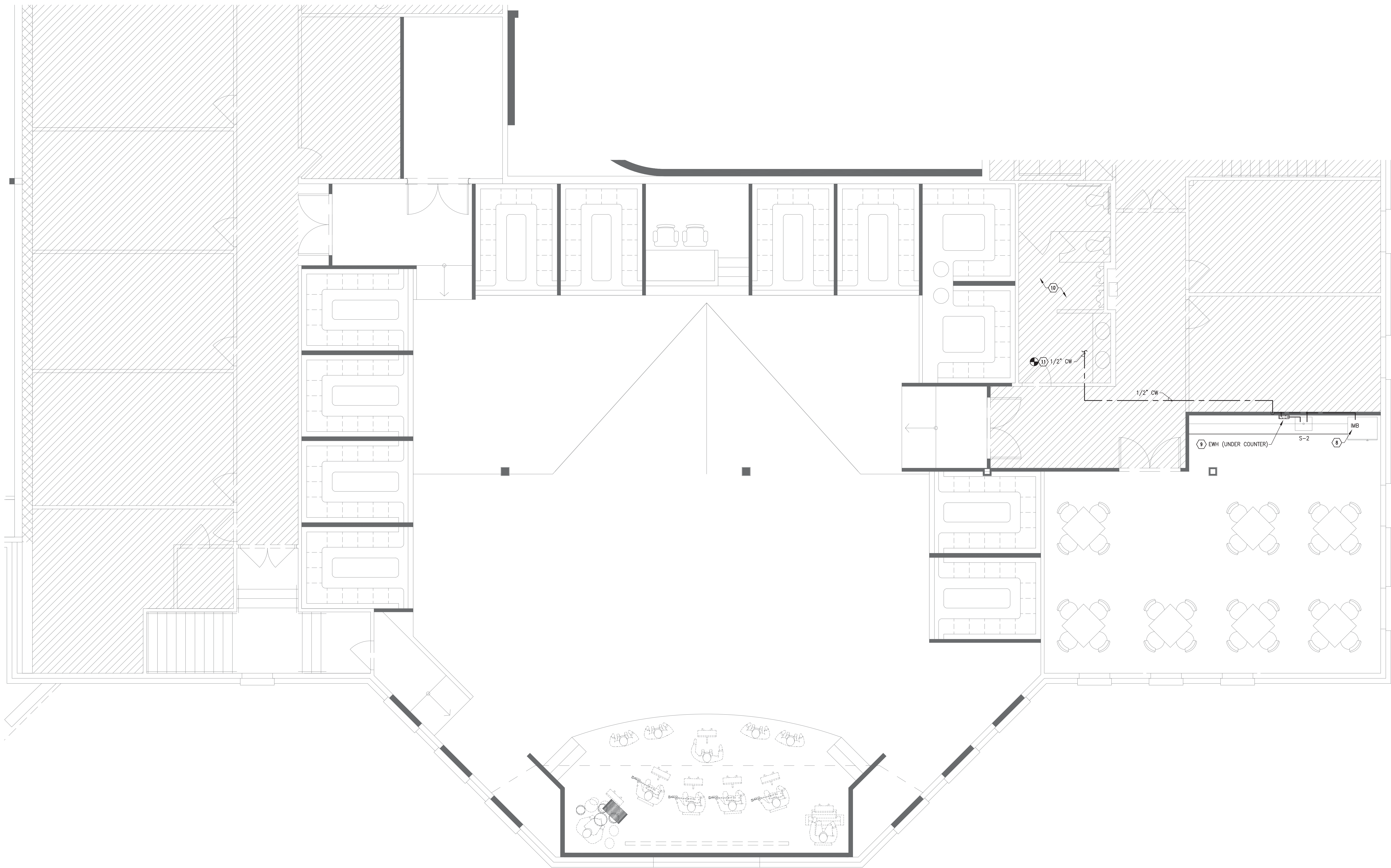

01 YOUTH SANCTUARY FLOOR PLAN - WATER - LEVEL 2
1/4" = 1'-0"

KEYNOTES * (K) *

- NOTE: NOT ALL KEYNOTES APPEAR ON EVERY 2ND FLOOR PLUMBING PLAN.
1. ORIGINAL 1995 PLANS DO NOT INCLUDE PLUMBING AND DO NOT INCLUDE WATER PIPING WITHIN BUILDING. FIELD VERIFY ALL CONDITIONS.
 2. 2ND FLOOR WOMEN'S RESTROOM SHALL BE RELOCATED AS SHOWN. NOTE THAT IT FLIPS ACROSS THE OLD CORRIDOR AND ALSO OFFSETS APPROXIMATELY 12" TO THE EAST. EXISTING CW AND HW PIPING SHALL BE DEMOLISHED AND REWORKED TO MAKE ROOM FOR THE NEW CORRIDOR AND TO RECONNECT TO NEW RESTROOM FIXTURES. CONTACT ARCHITECT OR ENGINEER WITH ANY CONCERNS OR FOR FURTHER DIRECTION.
 3. ALL PIPING SHALL BE REMOVED FROM EXISTING PLUMBING, RELOCATED, AND REWORKED TO NEW PLUMBING WALL. THERE SHALL BE NO PIPING VISIBLE IN NEW CORRIDOR. FIELD VERIFY ALL CONDITIONS.
 4. CONNECT NEW 1-1/2" CW TO EXISTING CW (SAME SIZE OR LARGER) IN MOST PRACTICAL LOCATION.
 5. CONNECT NEW 1/2" HW TO EXISTING HW (SAME SIZE OR LARGER) IN MOST PRACTICAL LOCATION THAT ALSO MINIMIZES PIPE LENGTH AND WAIT TIME FOR WATER AT LAV TO GET HOT.
 6. FIELD VERIFY THAT HOT WATER IS FUNCTIONING AND THAT IT DOES NOT EXCEED 110°F AT PUBLIC LAVATORIES. CONTACT ARCHITECT OR ENGINEER WITH ANY CONCERNS.
 7. PROVIDE WATER HAMMER ARRESTER (WHA) AND TRAP PRIMER (TP) BEHIND ACCESS PANEL IN WALL. COORDINATE EXACT LOCATION AND HEIGHT WITH FINISHES AND WITH ARCHITECT.
 8. PROVIDE ICE MAKER BOX (MB) AND 1/4" CW TO REFRIGERATOR. VERIFY LOCATION AND HEIGHT WITH MANUFACTURER'S CUT-SHEET. SEE ALSO SHEET P111 FOR DEDUCT-ALTERNATE.
 9. PROVIDE INSTANTANEOUS ELECTRIC WATER HEATER (EWH) UNDER COUNTER. INSTALL PER MANUFACTURER'S INSTRUCTIONS. SUPPLY WITH 1/2" CW AND RUN 1/2" CW AND 1/2" HW TO BREAKROOM SINK (S-2). SET HW SUPPLY TEMPERATURE TO 120°F (MAX.).
 10. NO PLUMBING WORK IN THIS RESTROOM. REFER TO ARCHITECTURAL, MECHANICAL, ELECTRICAL, AND OTHER PLANS FOR OTHER SCOPE IN THIS AREA.
 11. CONNECT NEW 1/2" CW TO EXISTING CW (SAME SIZE OR LARGER) IN MOST PRACTICAL LOCATION.
 12. IF DEDUCT-ALTERNATE #1 (REF: P112) IS ACCEPTED, THEN CAREFULLY REMOVE EXISTING PLUMBING FIXTURES AND RELOCATE THEM FOR REUSE.

PLUMBING NOTES

- A. REFER TO SHEET MEP001 FOR MEP GENERAL NOTES, SHEET P301 FOR GENERAL PLUMBING NOTES, AND SHEET MEP002 FOR MEP SPECIFICATIONS APPLICABLE TO ALL PLUMBING WORK.
- B. REFER TO SHEET P112 FOR ALTERNATE BID REQUIREMENTS.
- C. THERE ARE NO ORIGINAL BUILDING PLUMBING PLANS AVAILABLE. THOROUGHLY INSPECT EXISTING CONDITIONS, CONNECTION LOCATIONS, INVERT ELEVATIONS, ETC. AT BEGINNING OF PROJECT. CONTACT ARCHITECT OR ENGINEER WITH ANY SIGNIFICANT DISCREPANCIES.
- D. NO PIPING, EXISTING OR NEW, SHALL BE VISIBLE IN OCCUPANT AREAS WITHOUT WRITTEN APPROVAL FROM ARCHITECT OR OWNER.
- E. FIELD VERIFY THAT PIPING TO BE DEMOLISHED (DEMO'D) DOES NOT SERVE EQUIPMENT, FIXTURES, OR SYSTEMS TO REMAIN. CONTACT ARCHITECT FOR DIRECTION IF NECESSARY.
- F. ALL DEMOLISHED COLD WATER (CW) AND HOT WATER (HW) SHALL BE CUT BACK TO WITHIN 6" (MAX.) OF THE ACTIVE BRANCH TO AVOID CREATING "DEAD-ENDS".
- G. SEE ALSO PLUMBING FIXTURE SCHEDULE ON P301 FOR CONNECTION SIZES TO FIXTURES.
- H. REFER TO SHEET P111 FOR ALTERNATE BID REQUIREMENTS.

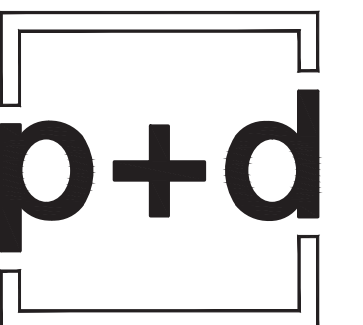

poole+drennan
design studio
931 N Edgely Ave
Dallas, Texas 75208
Ph: 972.707.0104
info@poole+drennan.com

COPYRIGHT
THESE DRAWINGS ARE THE PROPERTY OF
POOLE+DRENNAN DESIGN STUDIO AND
SHALL NOT BE DUPLICATED, DISCLOSED OR
REUSED WITHOUT THE WRITTEN CONSENT
OF POOLE+DRENNAN DESIGN STUDIO

DRAWN BY:
CHECKED BY:
DATE: **04.12.2017**
REVISIONS:

PROJECT NO.: **16054**
SHEET TITLE:
**PHASE I- YOUTH
SANCTUARY
FLOOR PLAN -
WATER**
SHEET NO.:

P214



FILE: G:\PROJECTS\POD\POD1611 - Binerrri Church Remodel\Drawings\P214 - POD1611.dwg
SCALE: 48 DATE/TIME: Apr 13, 2017 10:06pm
USER: FourPointMEP2 XREF(g): POD1611 - ARCH - LEVEL2 - FP.dwg